

T.29S., R.14W., W.M.

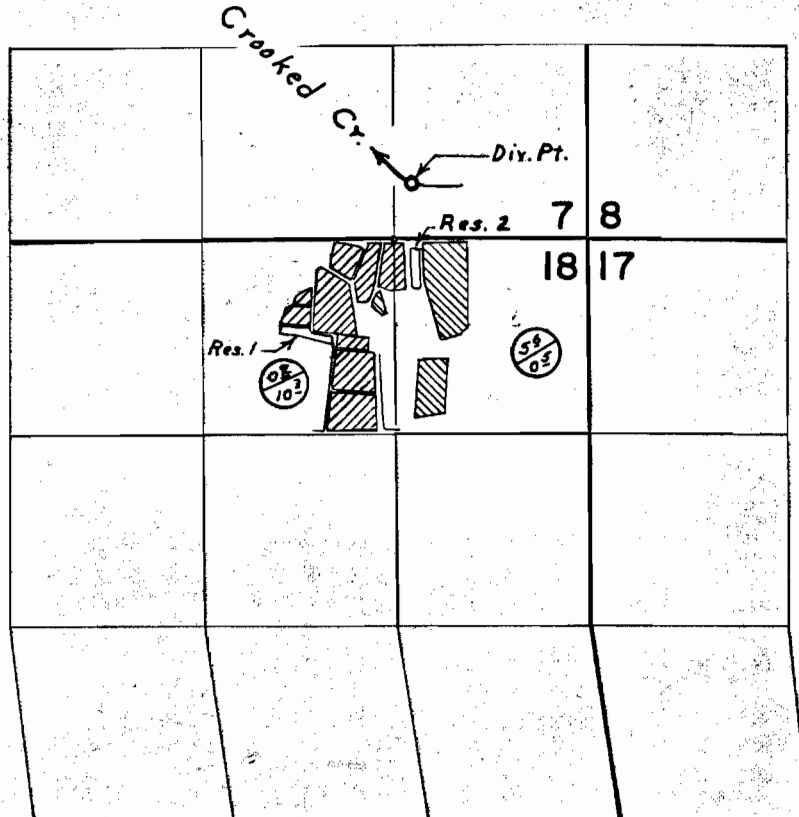

Div. Pts. located: Cr., 380' N. & 120' E.; Res. 1, 650' S. & 600' W.;  
 Res. 2, 200' S. & 140' E.; all from N.W. Cor. N.E. & N.E. & Sec. 18

Primary  
 Supplemental

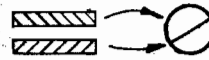

**FINAL PROOF SURVEY**  
 UNDER

R-45810                      R-5431  
 Application No. 45811      Permit No. 34185  
 IN NAME OF  
 MRS. GERTRUDE PEARL TUCKER  
 & MR. JAY HESS

Surveyed April 17, 1972, by L. E. Gould