

G-7551
51900

T. 2N. R. 34E. W.M

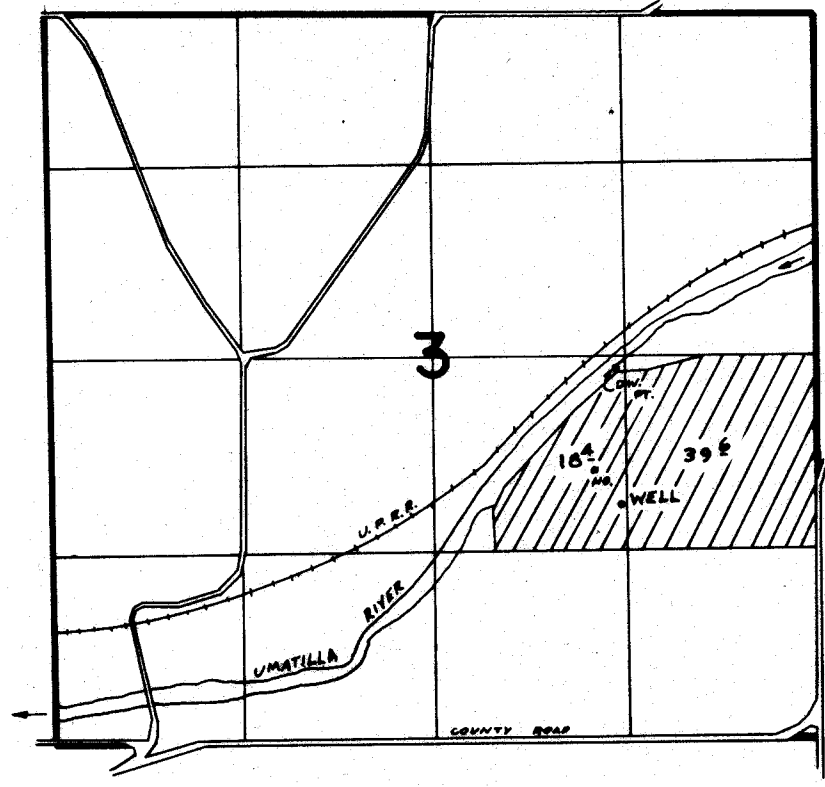

WELL LOC. 161'N & 1370'W FROM SE COR SEC 3

FINAL PROOF SURVEY UNDER

Application No. G-8125 Permit No. G-7551
IN NAME OF

GAIL L. McCARTY

Surveyed 7-26 1978, by R. BARWIN