

# T.16 & 17S., R.2 & 3E., W.M.

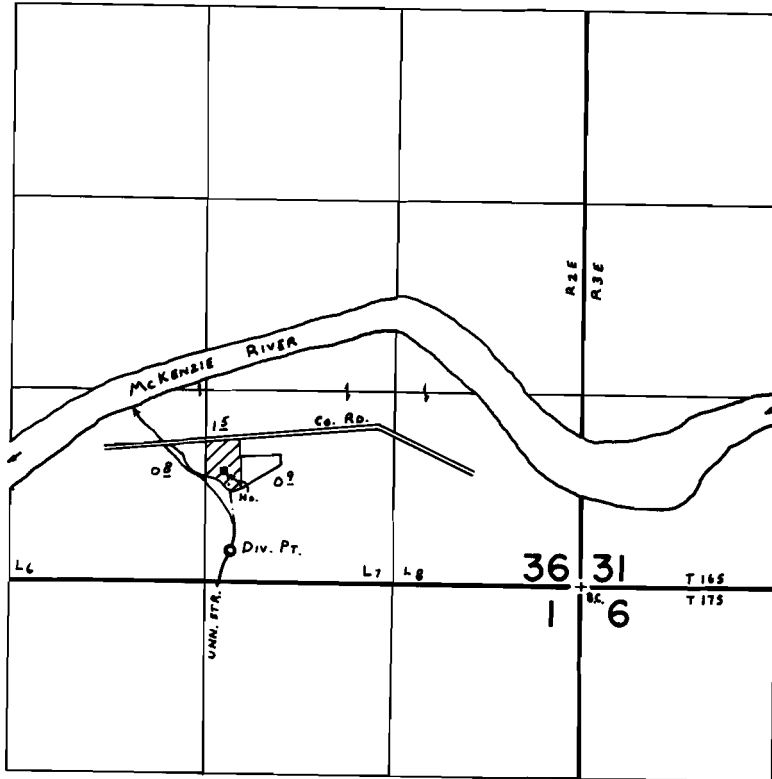

DIV. PT. LOC: 210' N. & 170' E. fr. S. 1/4 COR. SEC. 36.

## FINAL PROOF SURVEY UNDER

Application No. 44269. Permit No. 33068.....  
IN NAME OF

HENRY C. BRADFORD.....

Surveyed Sept. 11 1979, by C. L. HUGHES.....