

T.28S. R.8W. W.M.

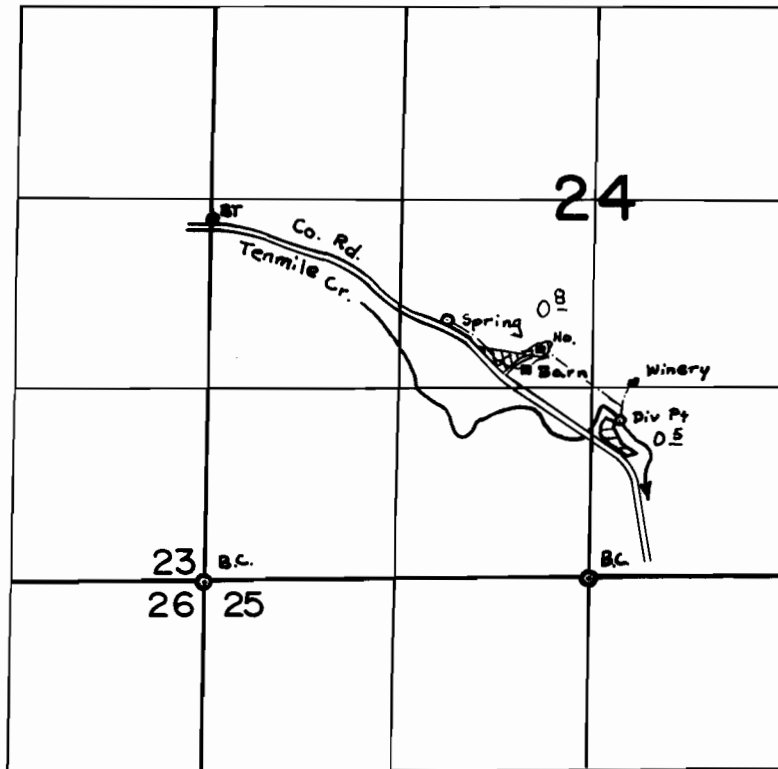

Spring Located 1750'N & 1000'W from S $\frac{1}{4}$ cor. Sec. 24
Div Pt. Located 1170'N & 200'E from S $\frac{1}{4}$ cor. Sec. 24

FINAL PROOF SURVEY
UNDER

Application No. 49893 Permit No. 37572
IN NAME OF

BJELLAND VINEYARDS

Surveyed Feb. 23 1978, by D. Sparks
April 8, 1980, by S. Donaldson