

P# 45360

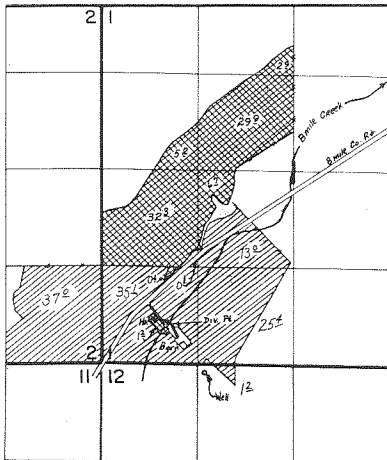

T. 1S. R. 13E. W.M.



Div. Pt. Located 520' N. & 900' E. from S.W. Cor. Sec. 1

Well located 100' S. & 1420' E. from NW. Cor. Sec. 12

FINAL PROOF SURVEY UNDER

G 6425 G 6035 
Application No. 60707 Permit No. 45360... 
IN NAME OF

TOM MAY

Surveyed Oct. 24, 1983, by T. J. Paul
APRIL 27, 1978 S. P. Applegate