

T. 31 S. R. 4 W. W.M.

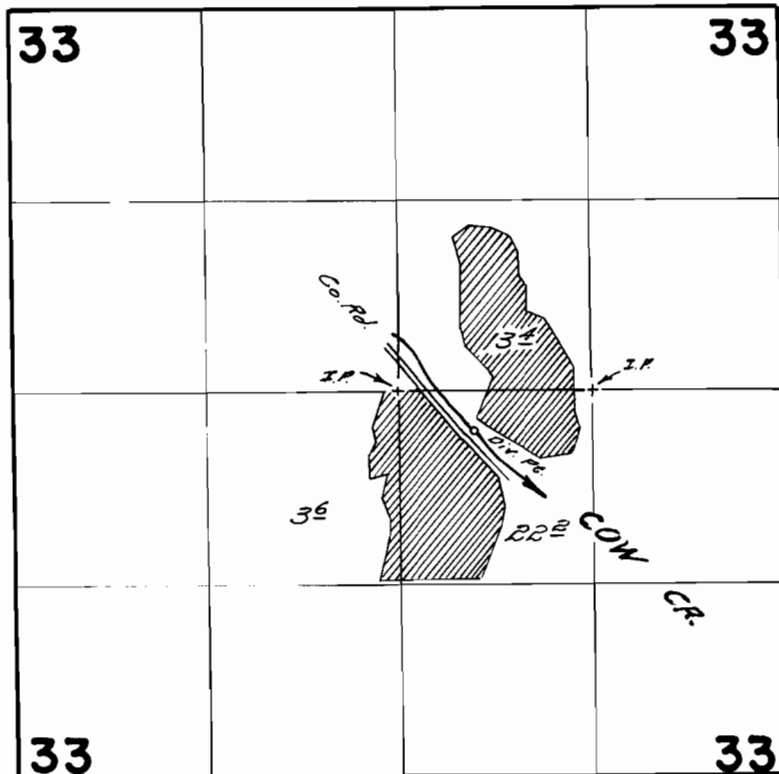

DIVERSION POINT LOCATED 280 FUS. & 520 FUS. E. FROM
CENTER 1/4 CORNER SECTION 33

FINAL PROOF SURVEY
UNDER

Application No. *35526* Permit No. *27501*
IN NAME OF

ROSS M. LENT

Surveyed *April 28, 1968*, by *W. d. Ruppert*