

P-39980

49031  
51974

# T9S. R27E. WM.

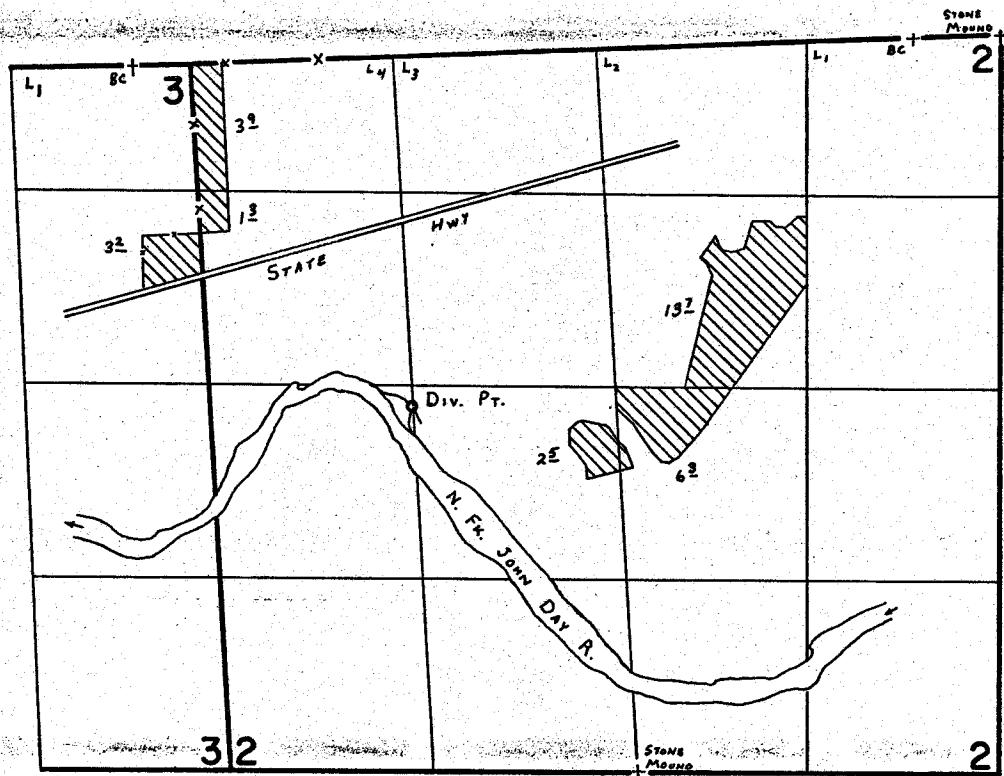

Div. Pt. Loc: 2320' S. & 1550' E. fr. N.W. Cor. SEC. 2.

## FINAL PROOF SURVEY UNDER

Application No. 52960. Permit No. 39980....  
IN NAME OF

**LEO L. & CLARA C. FLOWER**

Surveyed Oct. 17, 1977, by S. C. BROWN