

T.13 S., R. 29 & 30 E., W.M.

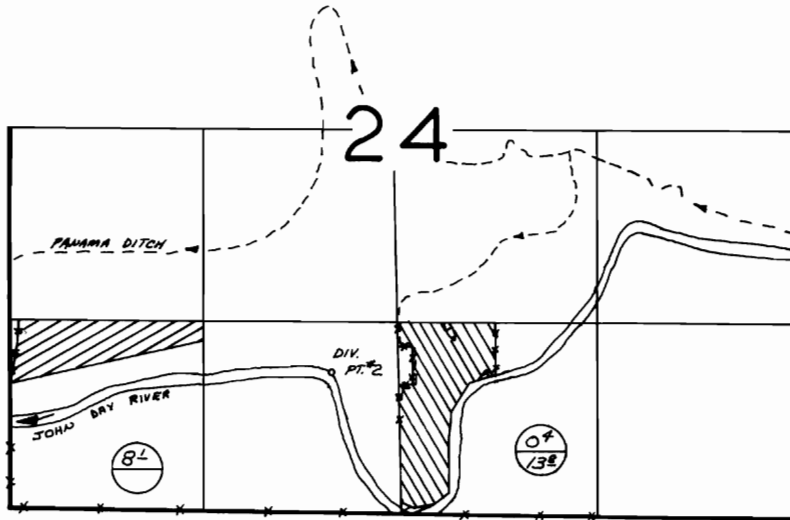

R.29 E.



DIV. PTS. LOCATED 390'S ± 2100' E FROM NW CORNER SECTION 25, T.13S., R.30E., W.M.
 ± 930' N, ± 2200' E. FROM SW CORNER SECTION 24, T.13S., R.29E., W.M.

R.30 E.

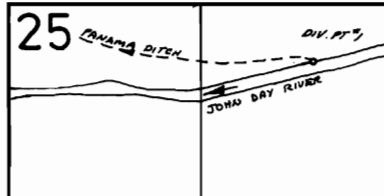

FINAL PROOF SURVEY
 UNDER

T-3897 ✓
 Application No. 54658 Permit No. 41442
 IN NAME OF

SHIRLEY N. LEE

Surveyed 8-25-83, 1983, by R. C. TITEL, JR.