

T. 37 S., R. 4 W., W.M.

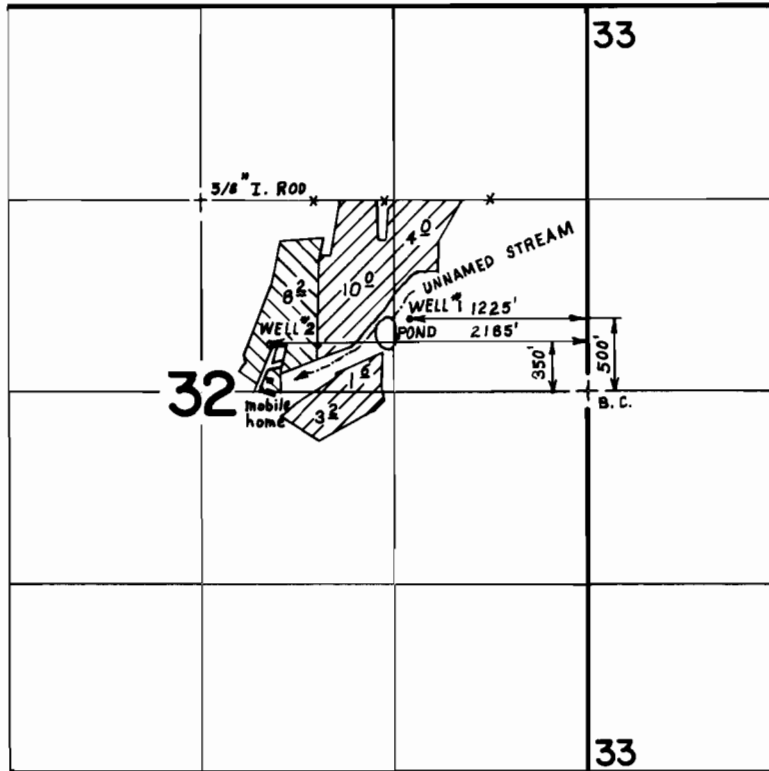

SCALE: 4" = 1 MILE

IRRIGATED from WELL #1.

IRRIGATED from WELL #2.

FINAL PROOF SURVEY UNDER

Application No. G-8925 Permit No. G-8331.....
IN NAME OF

PACIFIC CREST VINEYARDS, LTD.

Surveyed JUNE 8, 1982, by BRUCE R. SUND