

# T. 37 & 38 S. R. 5 W. W. M.

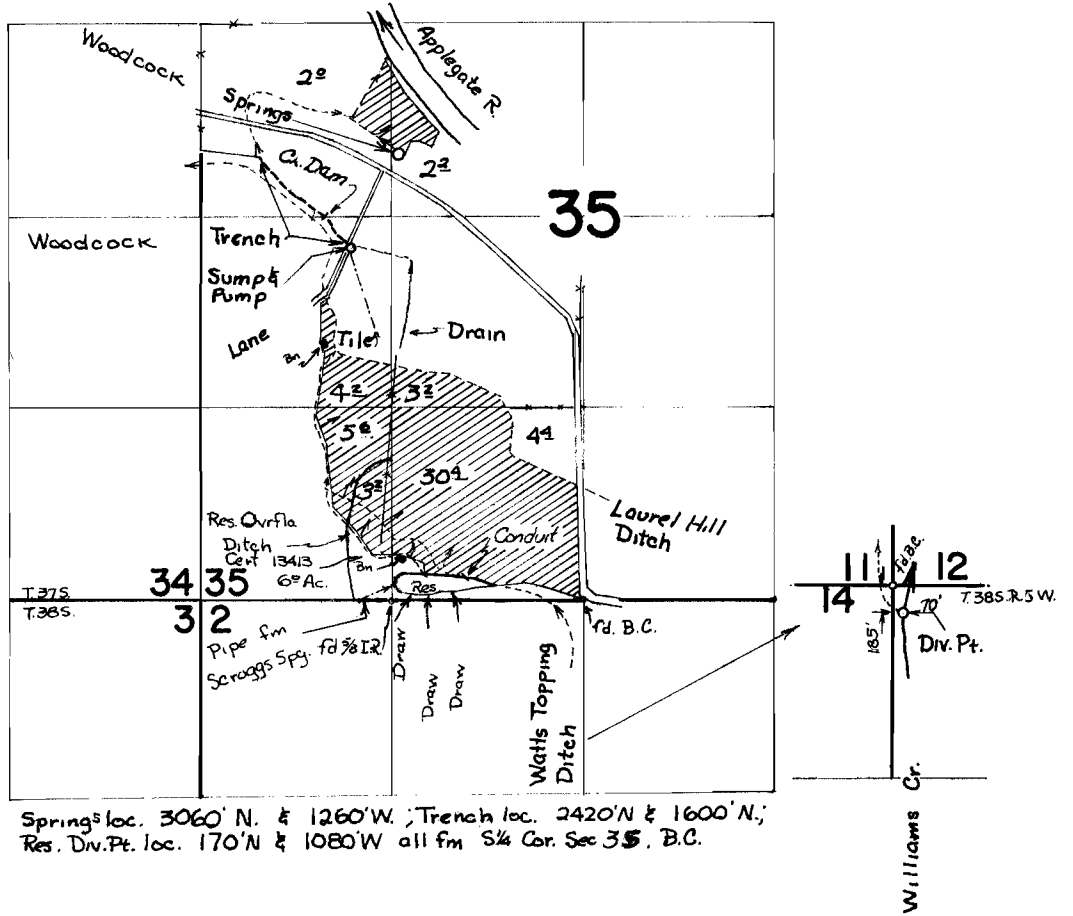

Springs loc. 3060' N. & 1260' W.; Trench loc. 2420' N. & 1600' N.;  
 Res. Div. Pt. loc. 170' N. & 1080' W. all fm S 1/4 Cor. Sec 35, B.C.

## FIELD BOOK SURVEY

UNDER

R 38699  
 38700

R 3862  
 29162

LYLE WOODCOCK

Surveyed 14 APR 1970 by D. R. BUELL