

T.15S., R.12E., W.M.

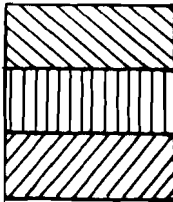
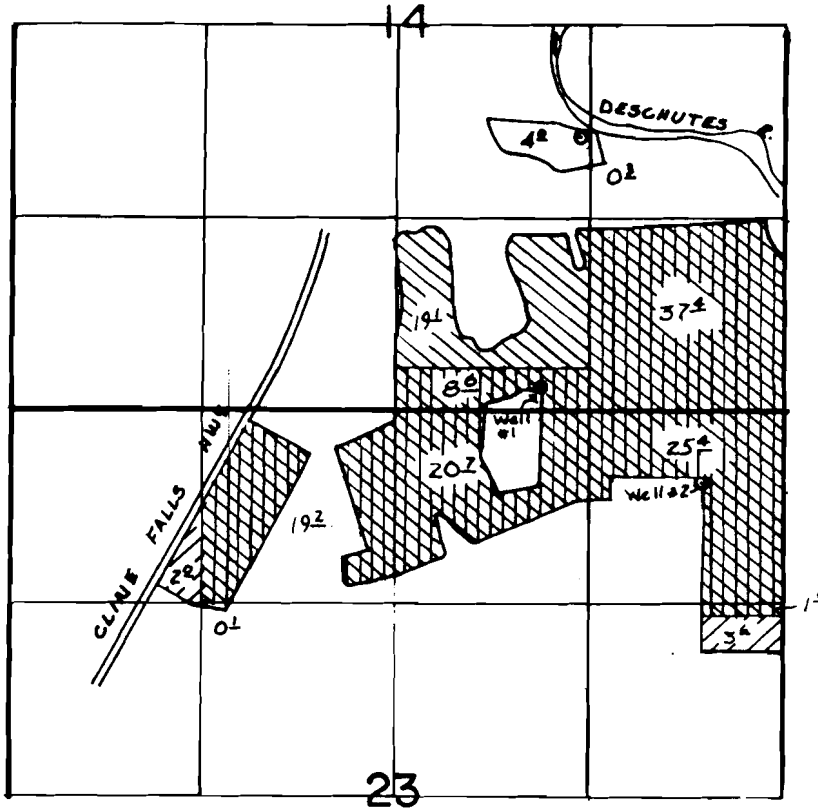

G-6284 Primary Well #1

G-9103 Supplemental Well #2

G-9103 Primary Well #2

Well #1 is 150' N and 1640' W of the NE corner of Sec. 23

Well #2 is 500' S and 550' W of the NE corner of Sec. 23

SCALE: 4" = 1 mile

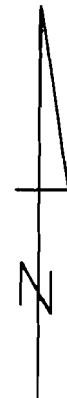

**FINAL PROOF SURVEY**  
UNDER

G-6764                      G-6284    *Coer. 52191*  
Application No. G-9932. Permit No. G-9103.... *and. 52185*  
IN NAME OF

**FRANK N. & GEORGANN A. CHASE**

Surveyed MAY 14, 1983, by L.H. NUNN.....

9103  
2-  
179-106 LGO