

T.9S, R.26&27E.W.M.

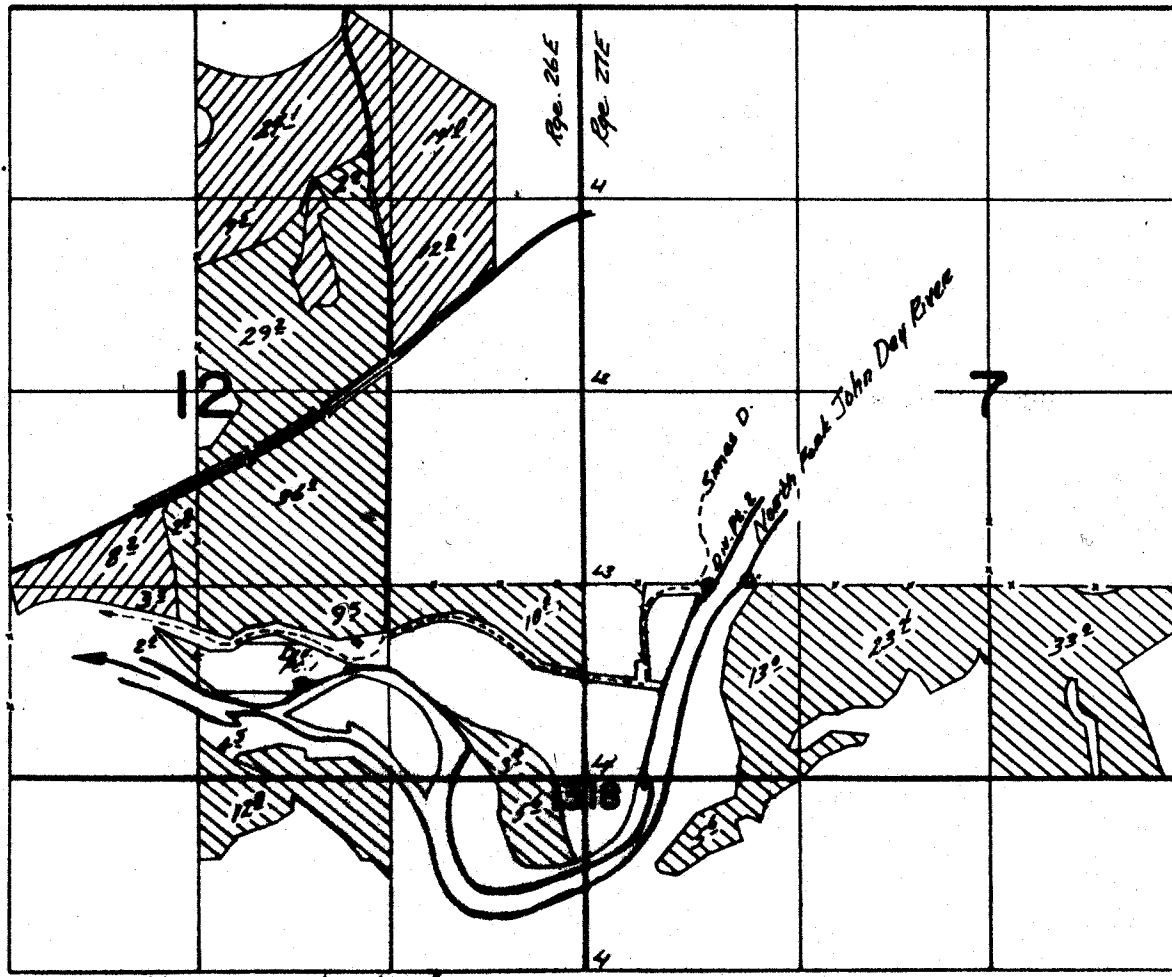

Dw. Pt. 1 - 630' N & 730' E from SW Cor. Sec. 12
 Dw. Pt. 2 - 1300' N & 850' E from SW Cor. Sec. 7
 Dw. Pt. 3 - 1340' N & 1120' E from SW Cor. Sec. 7

FINAL PROOF SURVEY UNDER

Application No. **52122** **39261** →  - Prim.
 307.7.B. Permit No. **24426** →  - Prim.
 IN NAME OF

FRED & ANNABELLE GASSNER

Surveyed July 13, 1979, by S.C. BROWN.....