

T.1N.,R.4W.,W.M.

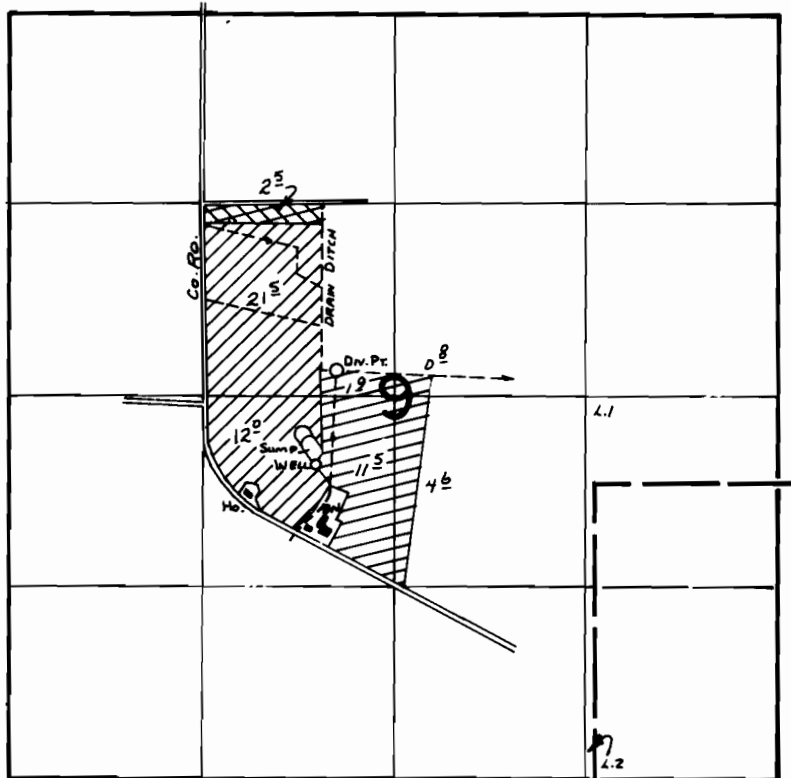

Well Loc: 460' S. & 2090' E from W1/4 Cor. Sec. 9
 Div. Pt.: 1150' S. & 920' E. from NW Cor. SE 1/4 NW 1/4 Sec. 9

FINAL PROOF SURVEY UNDER

Application No. G-10789 G-10051
 .63802.. Permit No. .47494..
 IN NAME OF

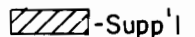

.....**DAVID W. HORNER**.....

Surveyed Oct. 31, 1983., by L.M. TOLL.....