

I. I. S. R. C. I. C., W. I. V.

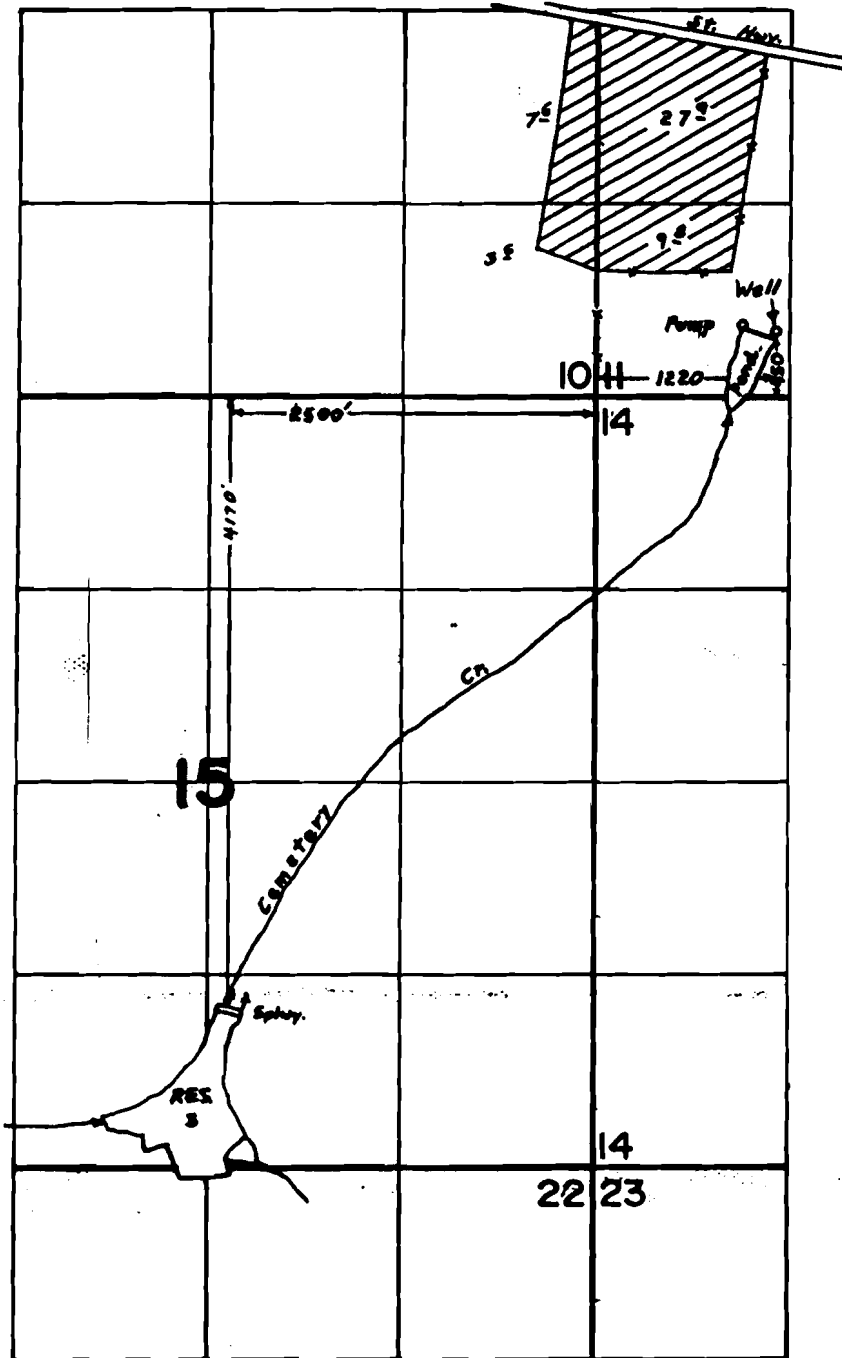

App'l. - 45538 - Primary

App'l. 6-7173 - Supplemental

**FINAL PROOF SURVEY  
UNDER**

45538                      34071  
R-45537                    R-5409  
Application No. G-7173    Permit No. G-6622  
**IN NAME OF**

**LES. SCHWAB TIRE CENTER, INC.**

Surveyed JUL. 11, 1978. by J.S. DONALDSON

C-52351

34071