

G-6561  
52362  
1 of 2

# T. 37S. R. 11E. W.M.

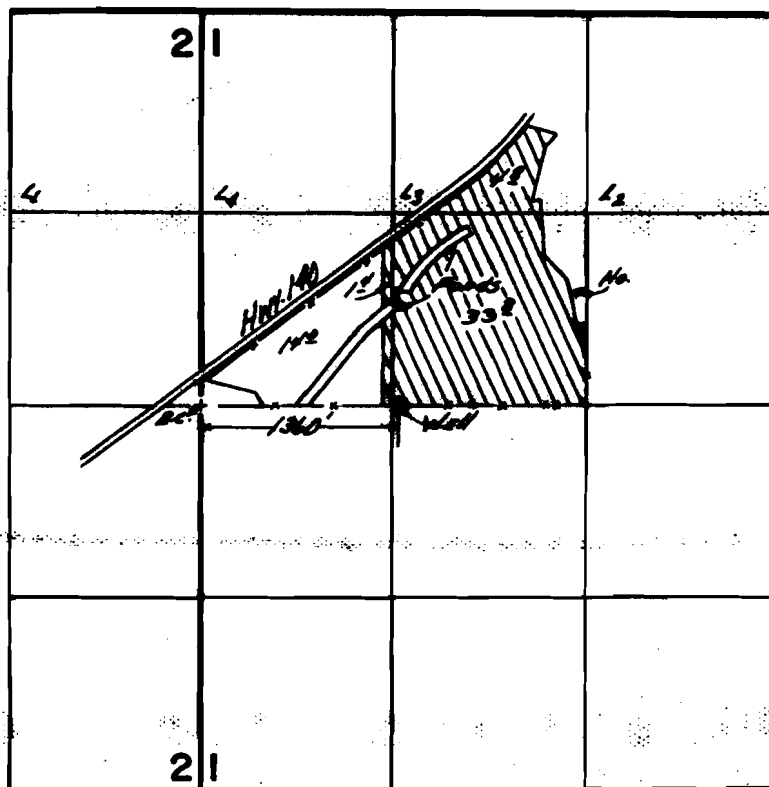

## FINAL PROOF SURVEY UNDER

Application No. G-7093. Permit No. G-6561...  
IN NAME OF

JOHN M. KEMPER

Surveyed Sept. 24 1979, by C.R. RODRIGUEZ.

RECEIVED  
NOV 17 1975  
WATER RESOURCES DEPT.  
SALEM, OREGON

EROSION  
DITCHES

2640'

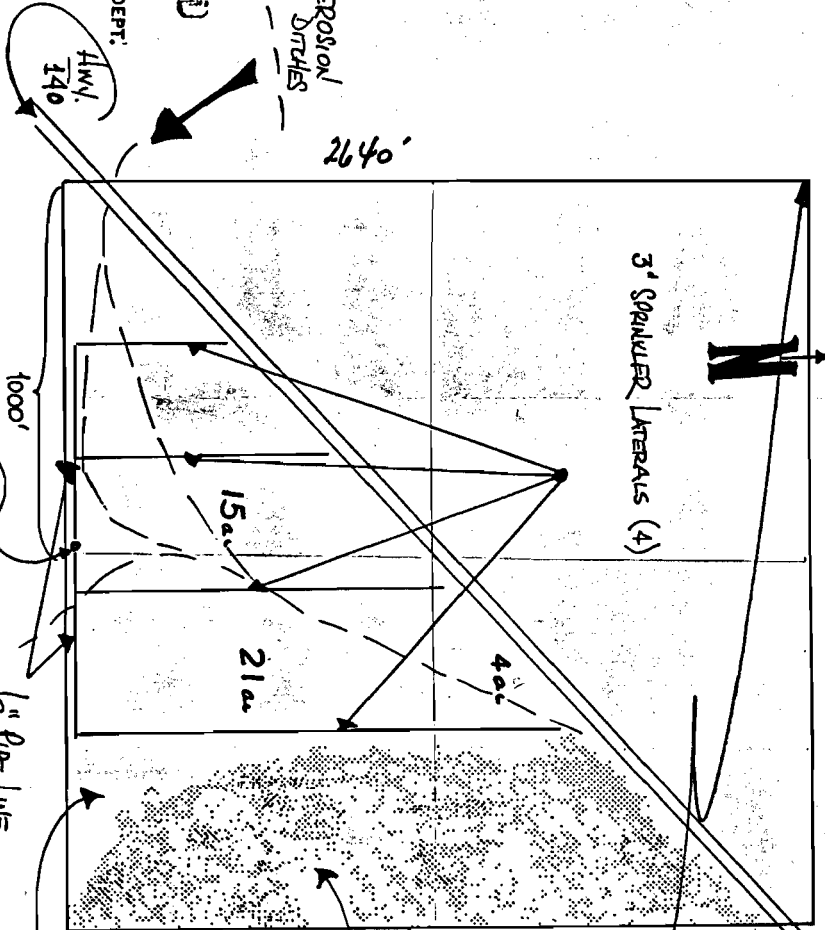

3' SPRINKLER LATERALS (4)

N

1000'

15a

21a

4a

Location OF SIL

6" FIRE LINE

TO LIVEVIEW

Wooded Area  
(EST. 30 ACRES)

Open Area  
(EST. 40 ACRES)

12" - 1 MILE

N.W. CORNER (1/4)  
SECTION 1  
TOWNSHIP 37 S  
RANGE 11 E.W.M.  
PAGE 124

John M. Kemper

Application No. 6-6561  
Permit :

Whiskey