

36863

52368

T.39S. R.19E. W.M.

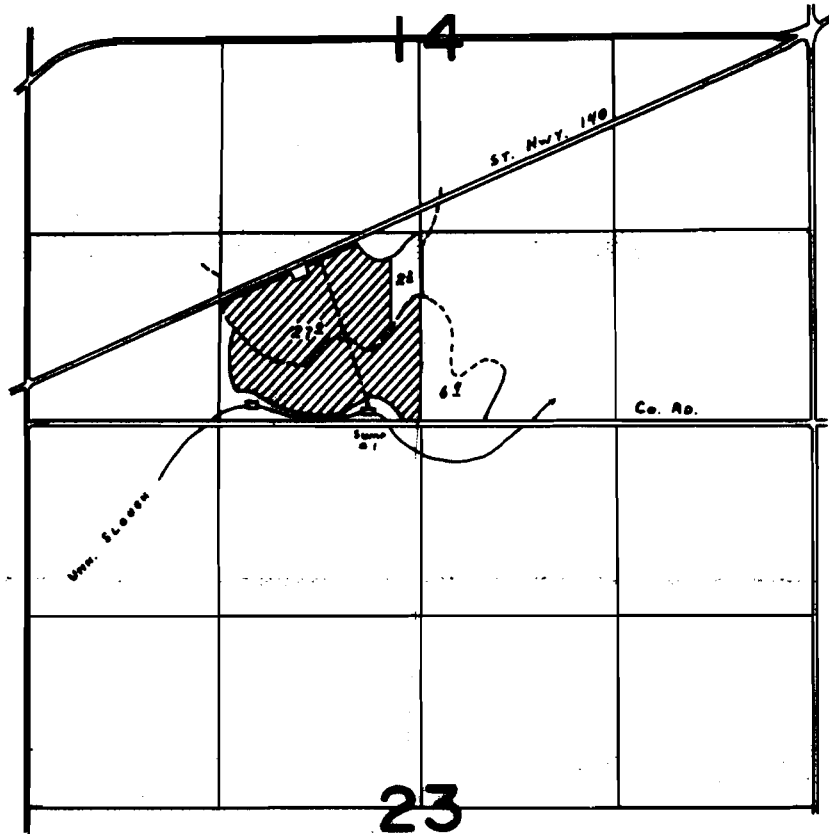

Sump #1 Loc: 70' N. { 320' W. }
 Sump #2 Loc: 110' N. { 1120' W. } } BOTH FROM S. 1/4 COR. SEC. 14.

FINAL PROOF SURVEY UNDER

Application No. **G-5535** **G-5420**
 ..49175.. Permit No. **36863**....
 IN NAME OF

.....**BURT A. SWINGLE**.....

Surveyed **JUNE 9** 19**80**, by **G. J. Hughes**.....