

T. 15S., R. 4W., W.M.

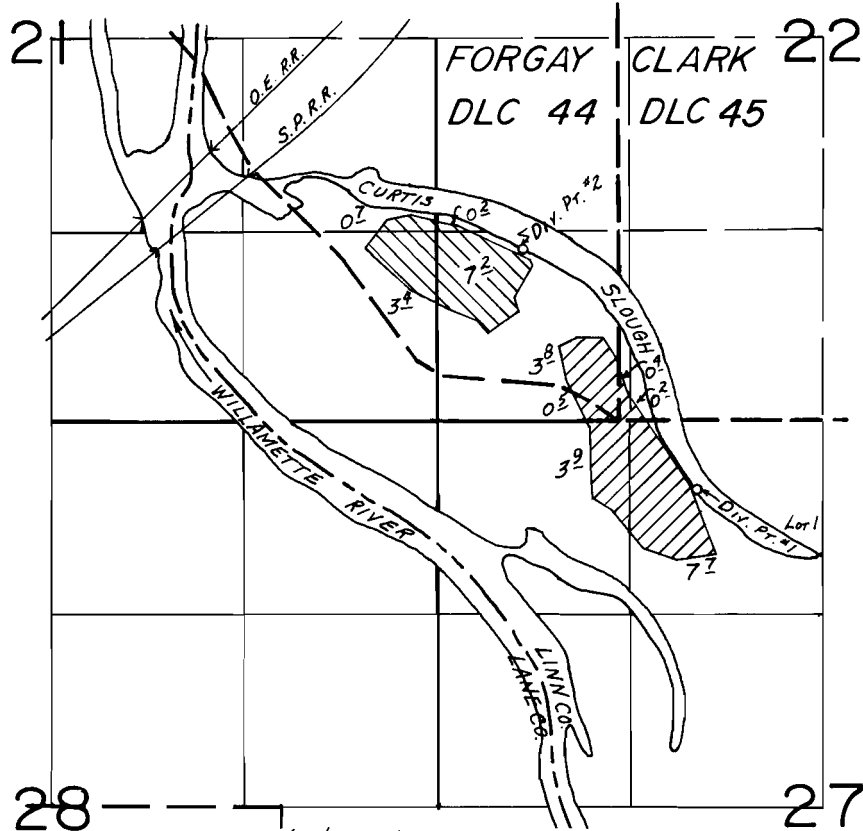

Div. Pt. #1 Loc. 470 S. & 1790 E. FROM NW COR. SEC. 27.
Div. Pt. #2 Loc. 1180 N. & 590 E. FROM SW COR. SEC. 22

FINAL PROOF SURVEY
UNDER

55941
55942

42695
42696



Application No. Permit No.
IN NAME OF

..... WILLIAM G. STRODA

Surveyed JULY 1 1980, by S.C. BROWN