

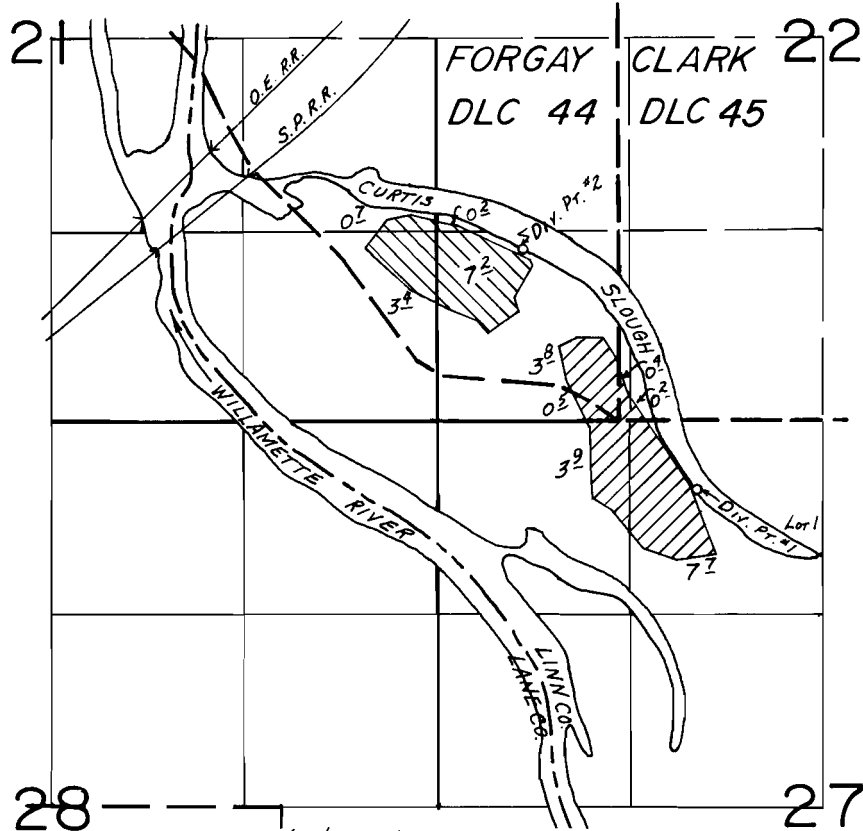

T. 15S., R. 4W., W.M.



DIV. PT. #1 LOC. 470 S. & 1790 E. FROM NW COR. SEC. 27.  
DIV. PT. #2 LOC. 1180 N. & 590 E. FROM SW COR. SEC. 22

**FINAL PROOF SURVEY**  
UNDER

55941	42695	
55942	42696	

Application No. .... Permit No. ....  
IN NAME OF

..... WILLIAM G. STRODA .....

Surveyed JULY 1 ..... 1980, by S.C. BROWN .....