

T7S R2W WM

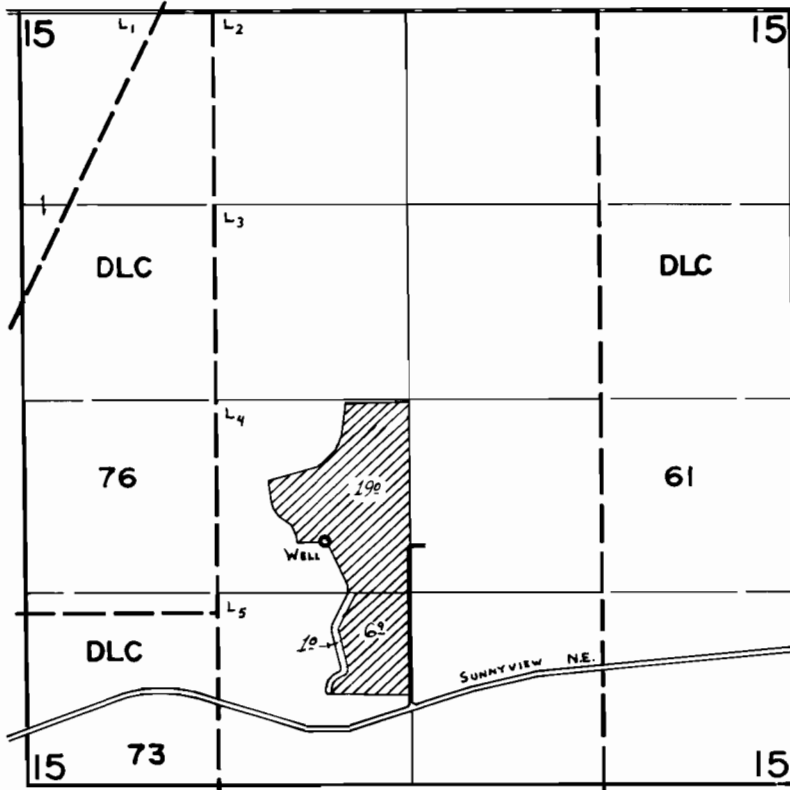

WELL Loc: 360' N. & 570' W. fr. S.E. Cor. Lot 4.

FINAL PROOF SURVEY UNDER

Application No. ~~9-7766~~ Permit No. ~~9-8138~~.....
IN NAME OF

.....**JOHN A. HAY**.....

Surveyed ~~May~~..... 19.80., by~~C. H. HARRIS~~.....