

# T.7S. R.3W. W.M.

Application No. G 9054  
Permit No. G 8393

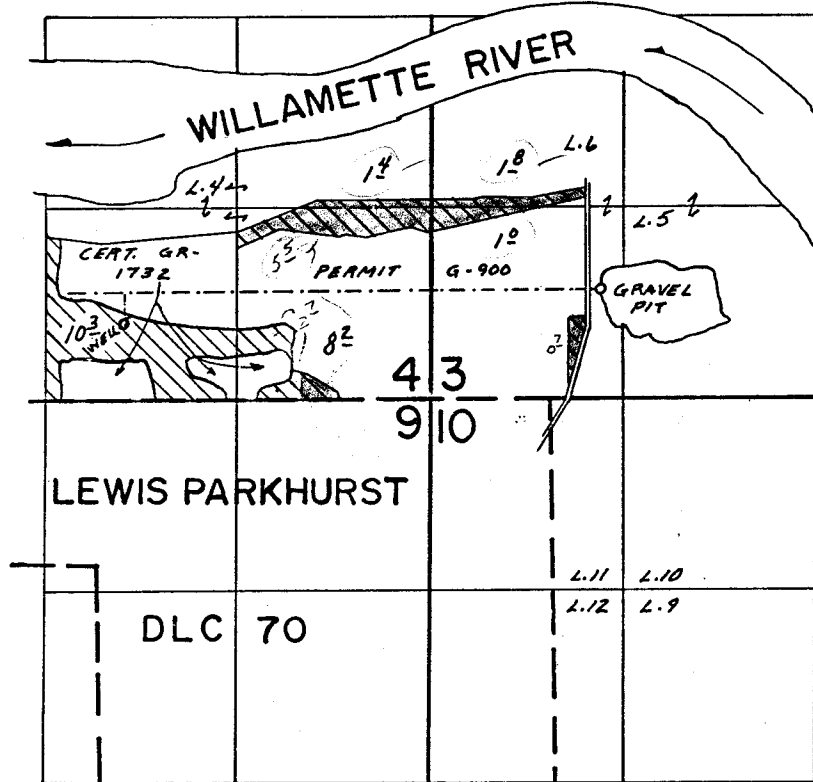

PIT WELL LOC. - 700' N & 350' E FROM NE COR. PARKHURST DLC 70  
WELL LOC. - 520' N & 530' E. FROM S 1/4 COR. SEC. 4

## FINAL PROOF SURVEY UNDER

Application No. G-6481 Permit No. G-6103  
IN NAME OF

RIVERKAID FARMS, INC.

Surveyed June 9 1976, by R. G. Mucken