

T.1N. R.14E. W.M.

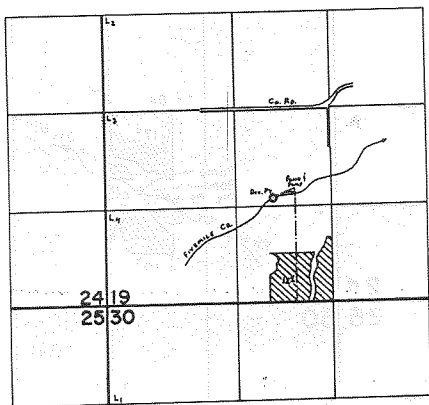

Div. Pr. Loc: 1430' N. & 780' W. fr. S. 1/4 Cor. Sec. 19.

**FINAL PROOF SURVEY**  
UNDER

Application No. 56840... Permit No. 42644  
IN NAME OF

ORVILLE D. THOMPSON.....

Surveyed June 27, 1979, by C. L. HUGHES..