

T. 35S., R. 1W., W.M.
SEC. 9

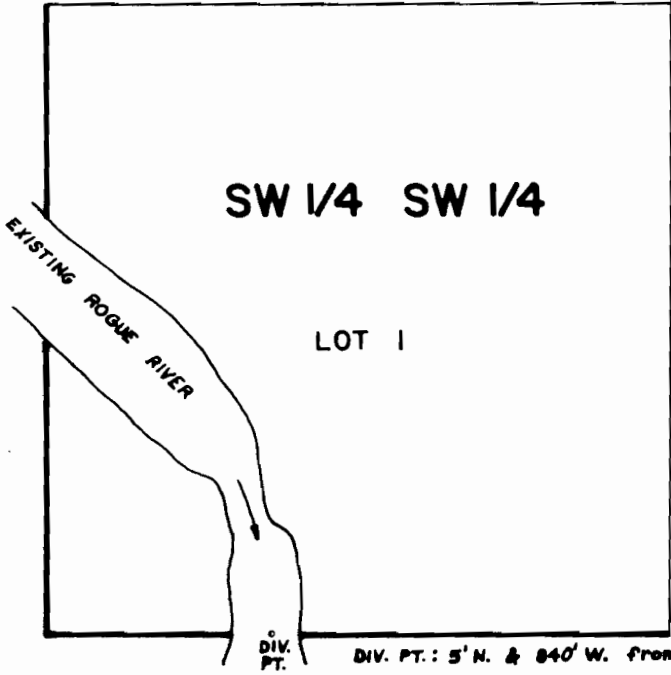

SCALE: 1" = 400'

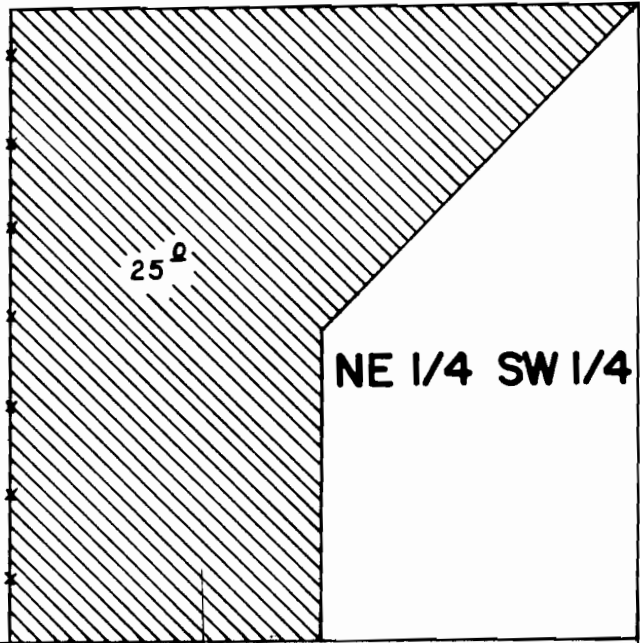

DIV. PT.: 5' N. & 840' W. from the S.E. COR. of LOT 1, SW 1/4 SW 1/4, SEC. 9.

FINAL PROOF SURVEY
UNDER

TRANSFER NO. 4291

Application No. Permit No.

IN NAME OF

..... DANIEL & FRANCES BROWN

Surveyed JULY 6... 19.83, by B.S. JAMES.....