

T. 7 S., R. 45 E., W.M.

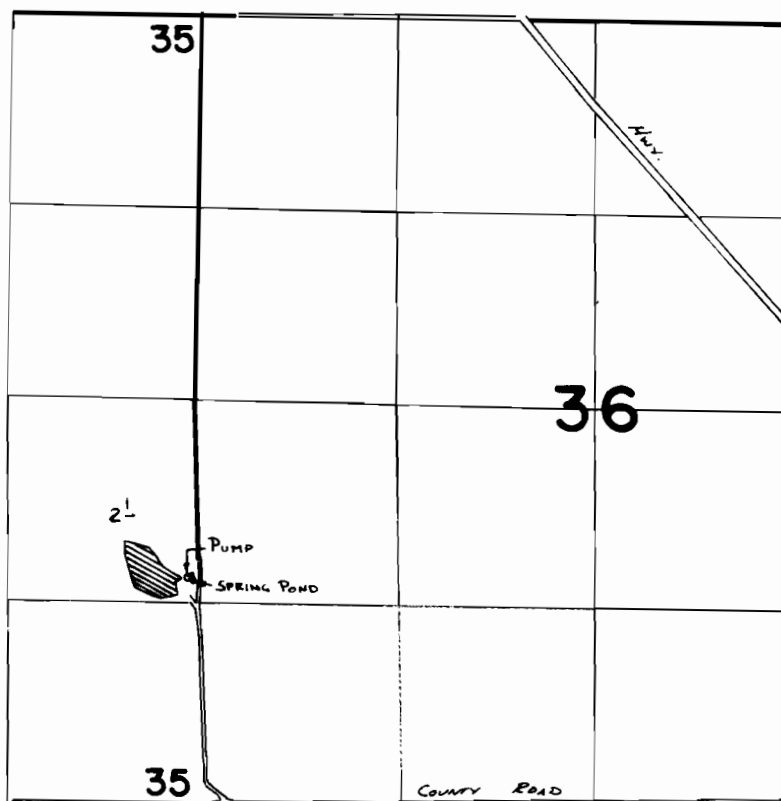

SPRING POND LOC: 1220'S. & 60' W. FROM E¹/₄ COR. SEC. 35

FINAL PROOF SURVEY
UNDER

SCALE: 1" = 1320'

Application No. **51271**... Permit No. **43182**....
IN NAME OF

.....**GEORGE BRYAN**.....

Surveyed **8-1**..... 19**84**., by **V.L. Church**.....