

# T12S. R6W. WM.

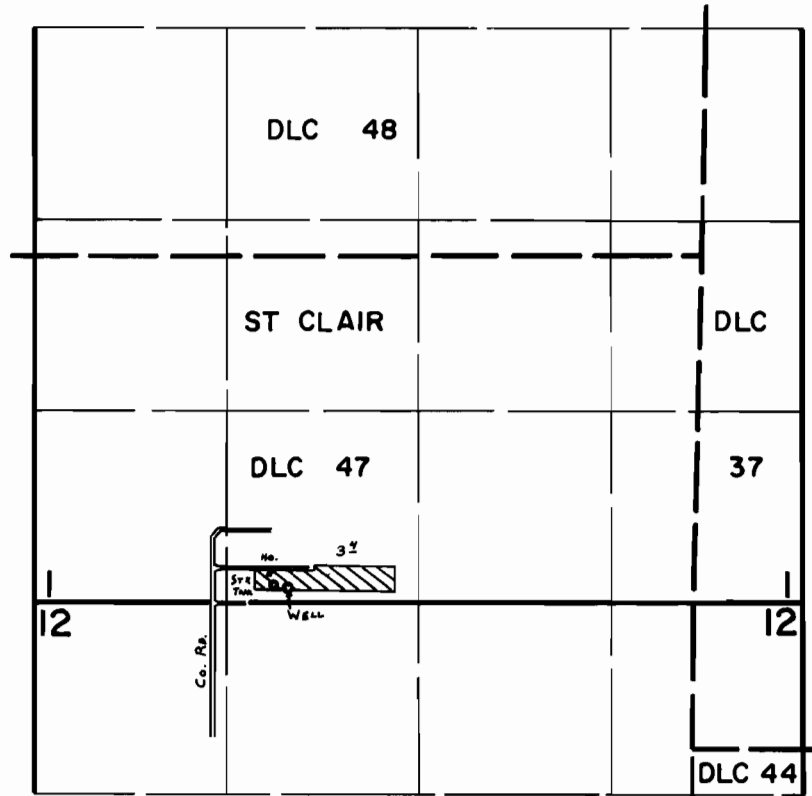

WELL LOC: 100' N. & 425' E. fr. S.W. CoR. of SE 1/4 SW 1/4 of Sec. 1.

## FINAL PROOF SURVEY UNDER

Application No. G-8423 Permit No. G-7714  
IN NAME OF

**CHARLES P. & DOROTHY CARROLL**

Surveyed Aug. 16, 1979, by C. L. HUGHES