

T.4S. R.1E. W.M.

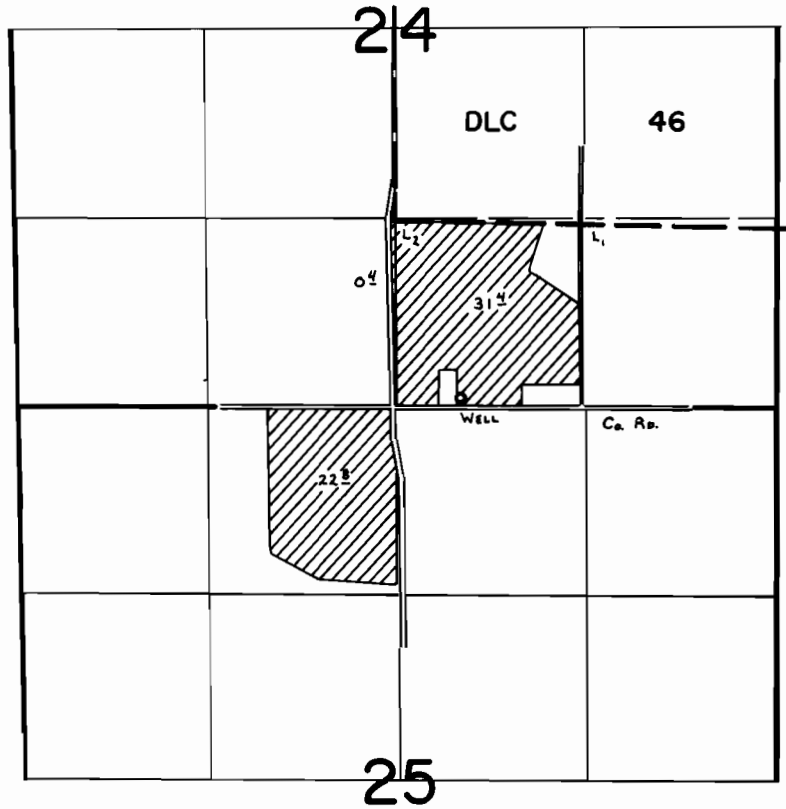

WELL Loc: 1210'S. & 430'E. fr. S.W. Cor. KLINGLER DLC 46.

FINAL PROOF SURVEY UNDER

Application No. ~~G-7588~~ Permit No. ~~G-7050~~....
IN NAME OF

JESSIE M. KOCH

Surveyed April 27, 1979, by C. L. HUGHES....