

T.15S. R.4W. W.M.

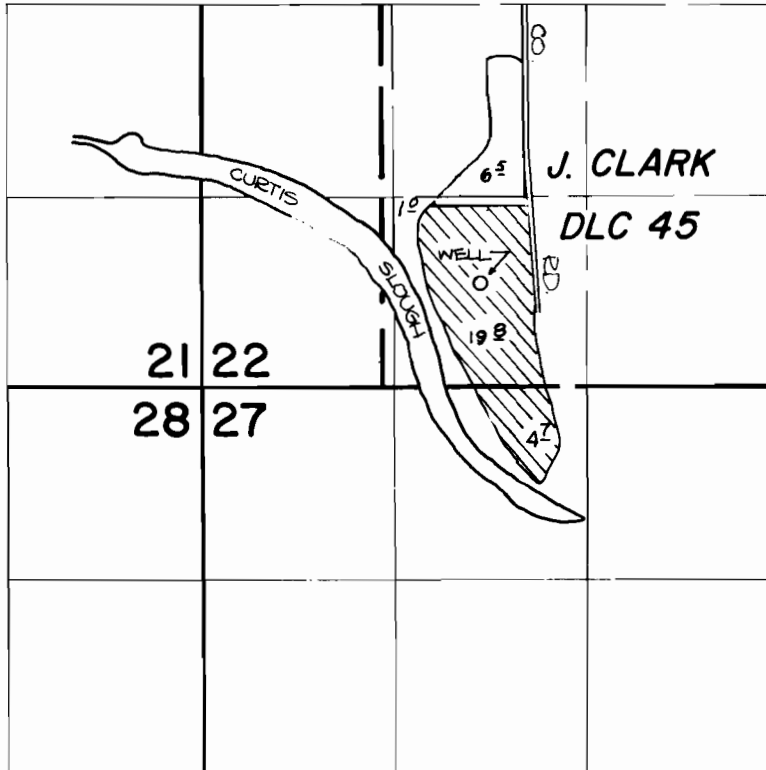

WELL IS LOCATED 700' N. AND 1910' E. FROM THE S.W. CORNER OF SECTION 22.

FINAL PROOF SURVEY UNDER

Application No. G-8155. Permit No. G-7895....
IN NAME OF

EUGENE CHEMICAL & RENDERING WORKS

Surveyed JULY 1, 1980, by S.C. BROWN.....