

# T.7 & 8S. R.4W. W.M.

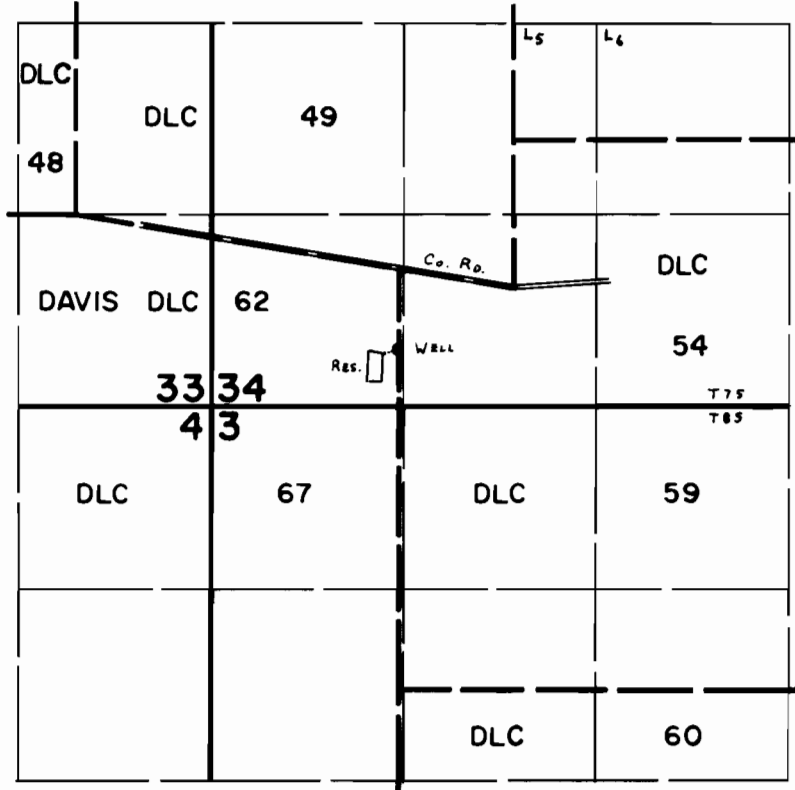

WELL Loc: 560'S. & 10' W. fr. N.E. COR. DAVIS D.L.C. 62.

## FINAL PROOF SURVEY UNDER

Application No. ~~G-5533~~ Permit No. ~~G-5418~~....  
IN NAME OF

**PAUL J. WEDEL**

Surveyed June 5, 1979, by G. L. HUGHES....