

G-5040
52677

T. 4N., R. 28E., W. M.

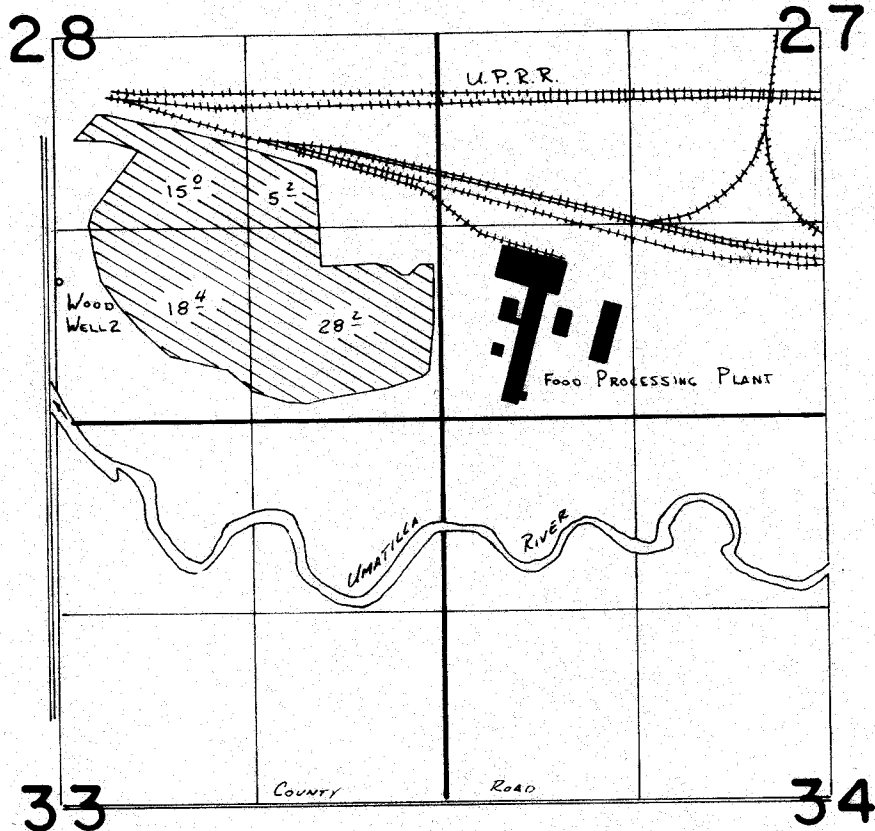

Wood Well 2 Loc: 1660' S. & 20' E. FROM CENTER COR. SECTION 28

FINAL PROOF SURVEY
UNDER

Application No. G:5940 Permit No. G:5040...
IN NAME OF

J. R. SIMPLOT CO.

Surveyed Jan. 25, 1984, by K. L. Church