

T. 4N., R. 29E., W.M.

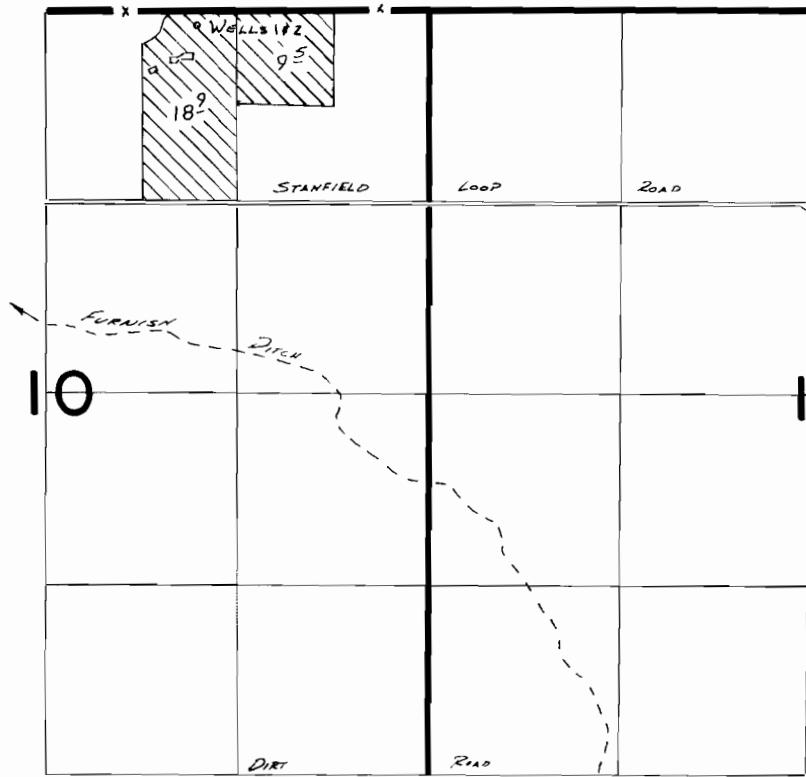

WELL 1 LOCATED 100'S & 1600' W. FROM NE COR. SEC. 10  
 WELL 2 LOCATED 100'S. & 1605' W. FROM NE COR. SEC. 10

**FINAL PROOF SURVEY**  
 UNDER

G-6774                      G-5339  
 Application No. **G-9410** Permit No. **G-8767**  
 IN NAME OF

**STEVEN R. & DEBORAH L. PICKER**

Surveyed *May 31* 1983, by *V.L. Church*  
*April 7*                      *18*                      *R. BARWIN*