

RECEIVED

T.26S. R.3W. W.M.

SEP 25 1979
WATER RESOURCES DEPT.
SALEM, OREGON

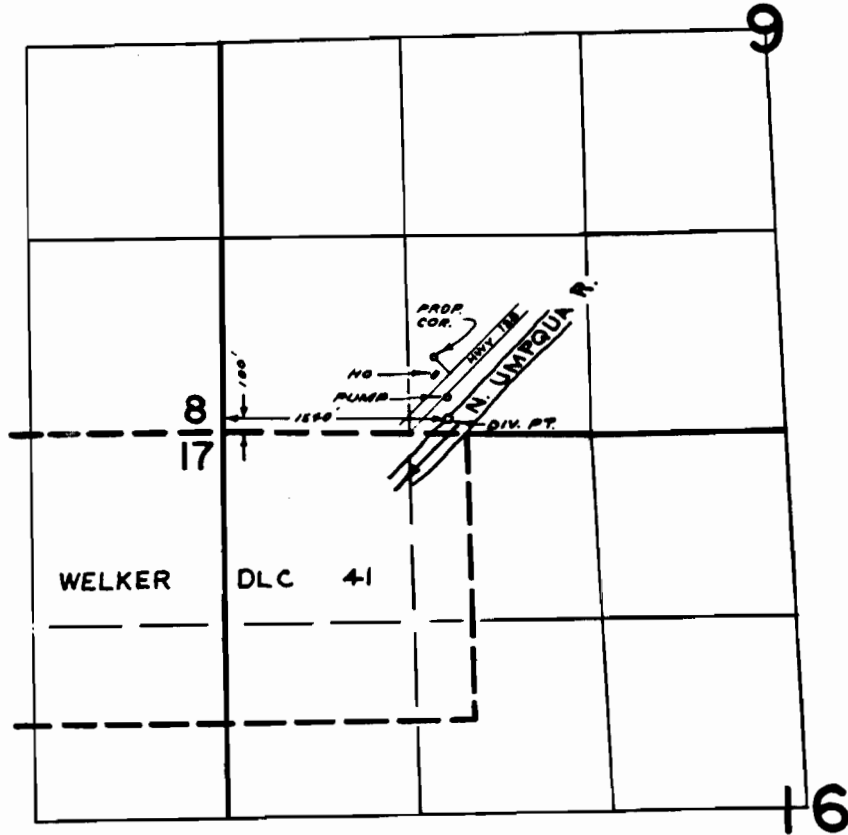

MAP TO ACCOMPANY

Application No. 59361 Permit No. 44645
IN NAME OF

ORBIE D. & NANCY E. COPLIN

Surveyed SEPT. 18, 1975, by R. MUCKEN