

T.39S., R.7W., W.M.

SEC. 19

NW 1/4 NE 1/4

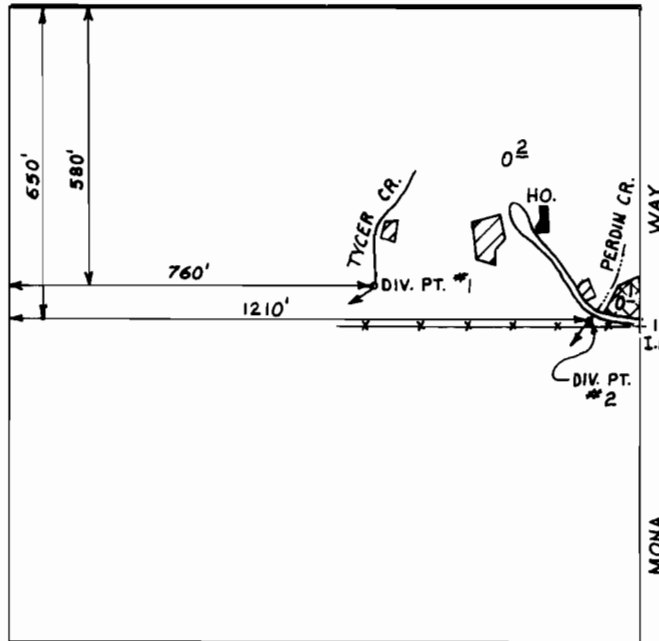

SCALE: 1" = 400'

IRRIGATED from TYCER CR.

IRRIGATED from PERDIN CR.

FINAL PROOF SURVEY
UNDER

Application No. 51514 Permit No. 38877....
IN NAME OF

.....JERRY WAYNE JENSON.....

Surveyed AUG. 25. 19.82, by BRUCE R. SUND.