

# T.2S.R.4E.W.M.

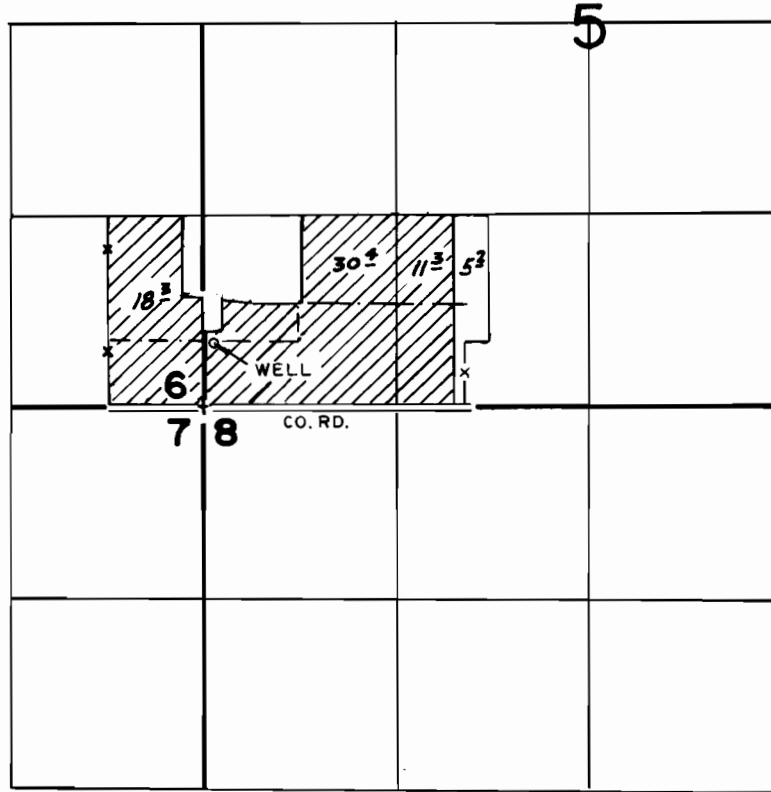

WELL LOC. : 450' N. & 50' E. FROM SW. COR. SEC. 5

## FINAL PROOF SURVEY UNDER

Application No. G-8961 Permit No. G-8440....  
IN NAME OF

..... ARNOLD MOORE .....

Surveyed APRIL 11, 1980, by R.G. MUCKEN.....