

T. 31S., R. 4W., W.M.

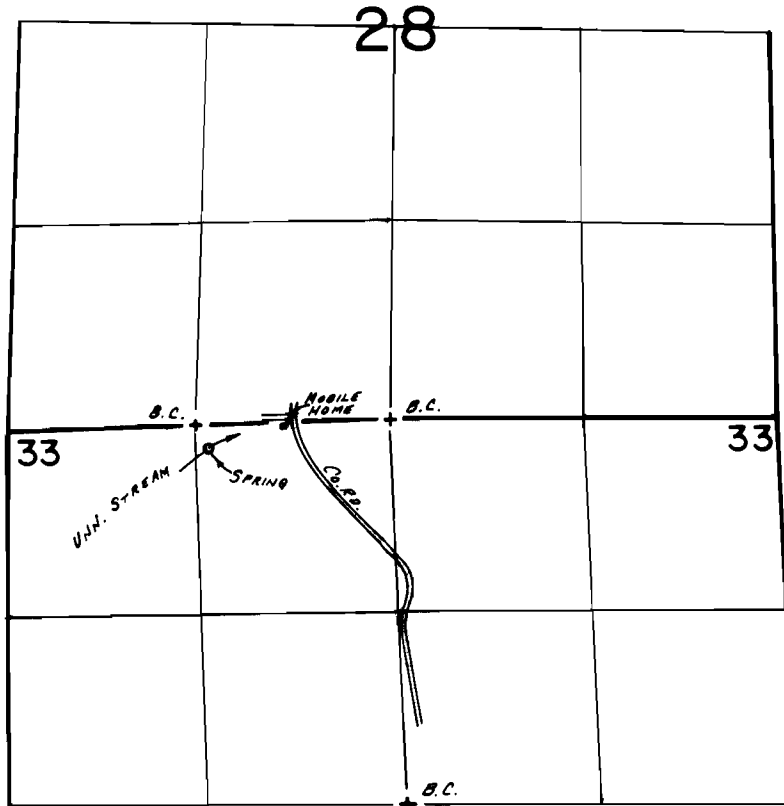

DIV. PT. LOC.: 150' S. & 90' E. FROM NW COR. NE 1/4 NW 1/4 SEC. 33

SCALE: 1" = 1320'

**FINAL PROOF SURVEY**  
UNDER

Application No. 56441. Permit No. 42813.....  
IN NAME OF

.....BRUCE DOUGLAS HOWARD.....

Surveyed NOV. 25, 1983, by D. CLARK.....