

G - 7174
52873
T10231

T.28S.,R.16E.,W.M.

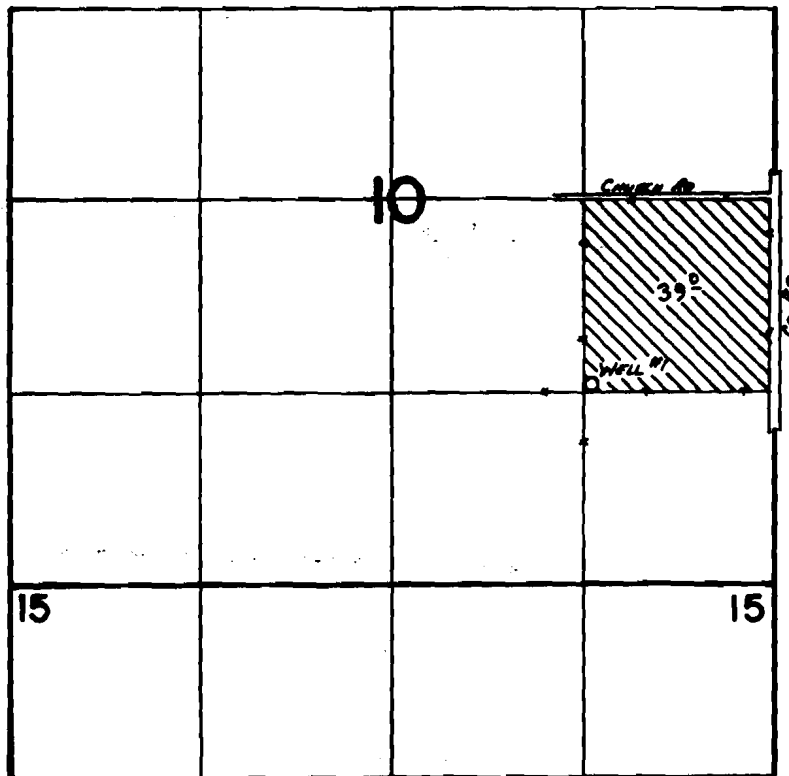

Well Loc.: 60' N. & 60' E. from SW Cox NE 1/4 SE 1/4 Sec. 10

FINAL PROOF SURVEY UNDER

Application No. G-7729. Permit No. G-7174.....
IN NAME OF

EMIL & RENATE WOLFSTRUM...

Surveyed Oct. 12, 1983, by L.M. TOLL.....