

T. 4N., R. 28E., W. M.

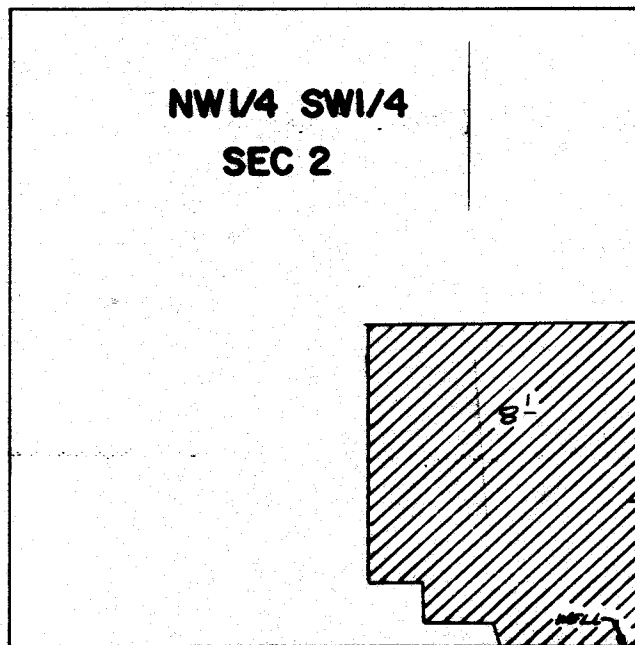

WELL LOCATED 20' N + 40' W. FROM SE COR OF NW 1/4 SW 1/4 SEC 2

SCALE 1" = 400'

FINAL PROOF SURVEY
UNDER

Application No. G:3114 Permit No. G:2909
IN NAME OF

C. N. McJUNKIN

Surveyed 6-18 1988, by Thomas L. Church