

T. 5N. R. 28E. W.M.

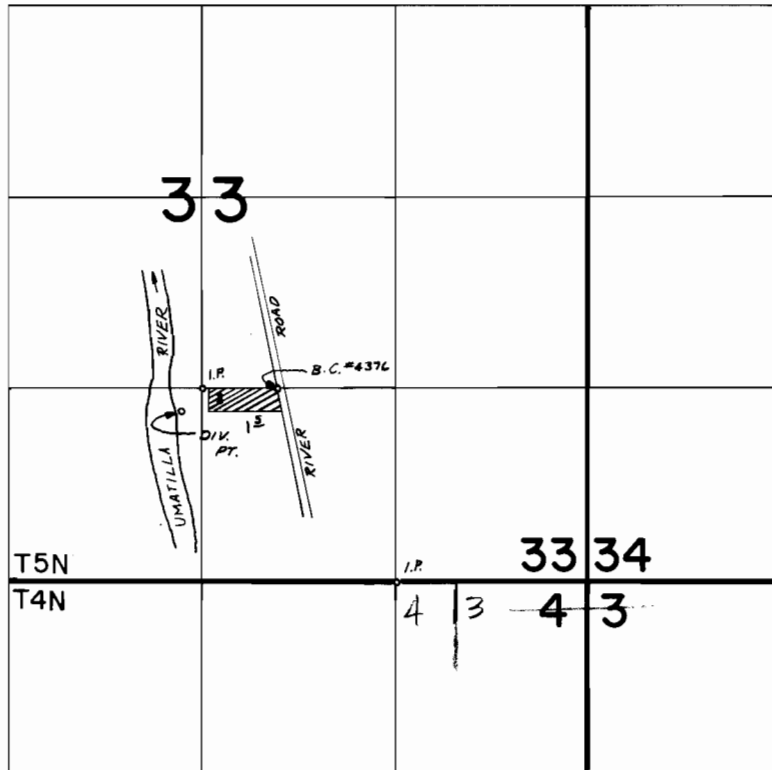

DIV. PT. LOC. 160'S & 150'W FROM NW COR OF SW1/4 OF
SE 1/4 OF SEC 33

FINAL PROOF SURVEY UNDER

Application No. 50472... Permit No. 38119...
IN NAME OF

FLOYD E. WILLARD

Surveyed 2-13 1978, by R. BARWIN