

# T14S. R5W. WM.

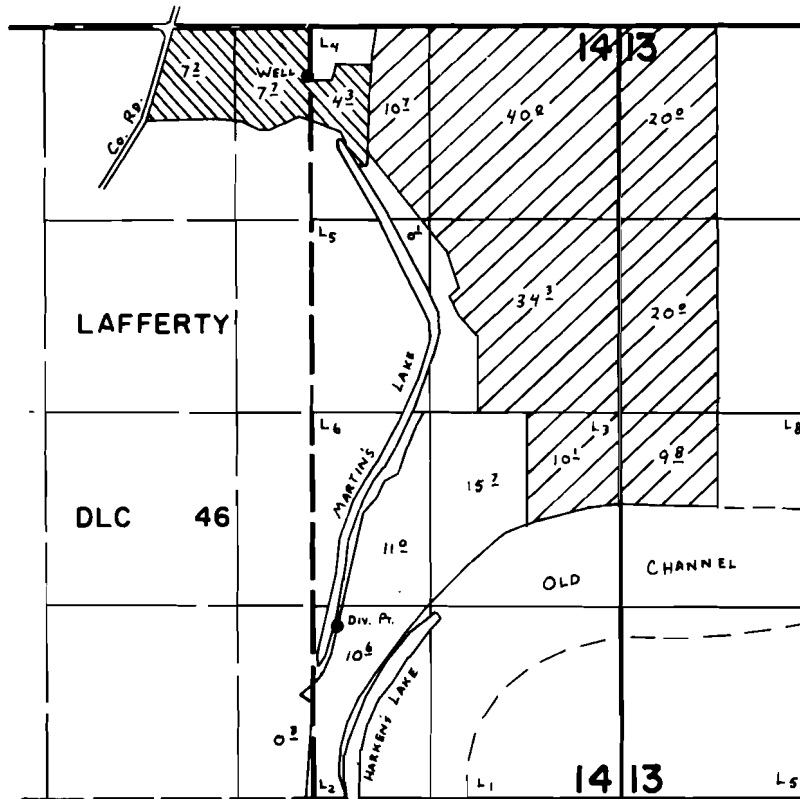

WELL LOC: 340'S. & 20'W. fr. N.E. COR. LAFFERTY DLC 46  
 Div. Pt. LOC: 1190'N. & 160'E. fr. S.W. COR. LAFFERTY DLC 46  
 [Diagonal hatching symbol] - PRIMARY IRRIGATION fr. WELL (APP. G-8662)  
 [Cross-hatching symbol] - SUPPLEMENTAL IRRIGATION fr. MARTIN'S LAKE DIV. PT. (APP. 57504)

## FINAL PROOF SURVEY UNDER

G-8662                      G-8317  
 Application No. 57504 Permit No. 43515.....  
 IN NAME OF

.....WILLIAM H. VOLKER.....

Surveyed Sept. 6, 1979, by C. L. HUGHES...