

T. 6N., R. 6W., W.M.

SECTION 22

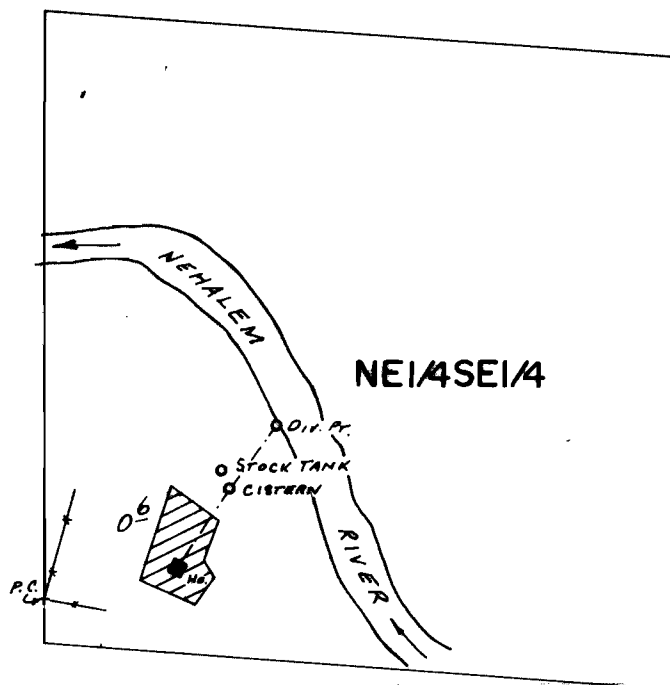

*Div. Pt. Loc: 770'S. & 830'W. FROM E. 1/4 Cbr. SEC. 22.*

SCALE: 1" = 400'

**FINAL PROOF SURVEY**  
UNDER

Application No. 61762 Permit No. 45831.....  
IN NAME OF

JAMES L. and/or VERONICA M. COLLIER

Surveyed July 11 1984, by B.W. BISHOP.....