

T. 3N. R. 29 E. W.M.

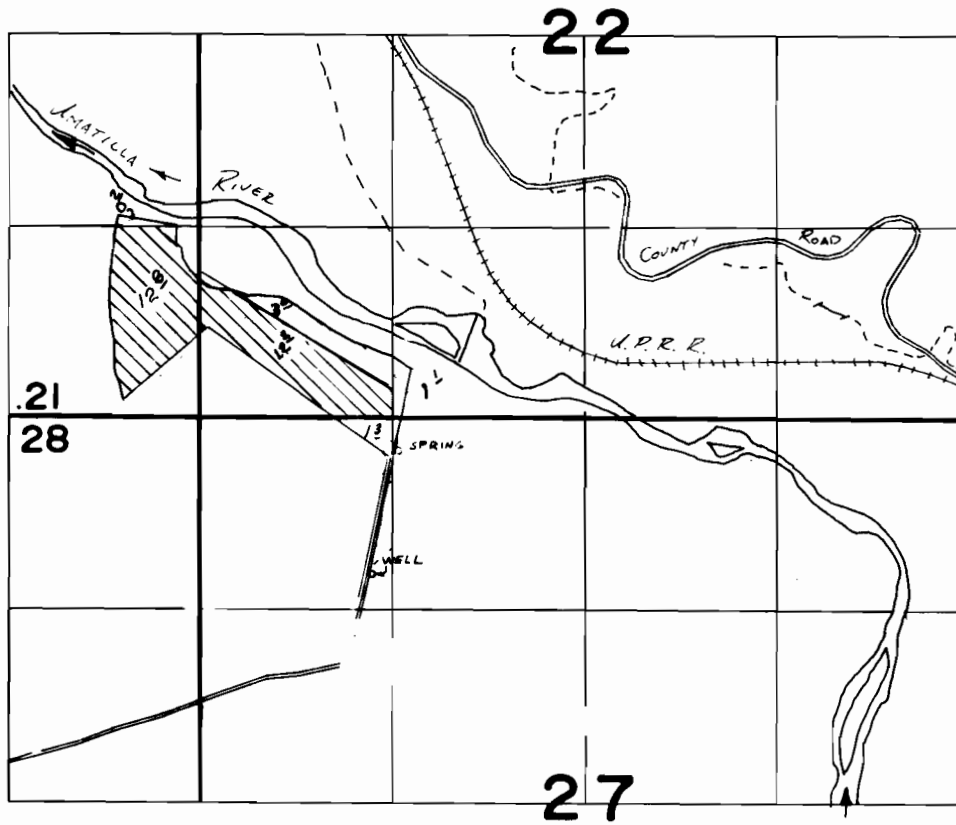

SPRING LOCATED 230' SOUTH AND 1350' EAST FROM NW COR. SEC. 27

FINAL PROOF SURVEY UNDER

Application No. 53887 Permit No. 40208
IN NAME OF

RON HOLEMAN

Surveyed 3-16 1978, by R. BARWIN