

T. 4N., R. 29E., W.M.

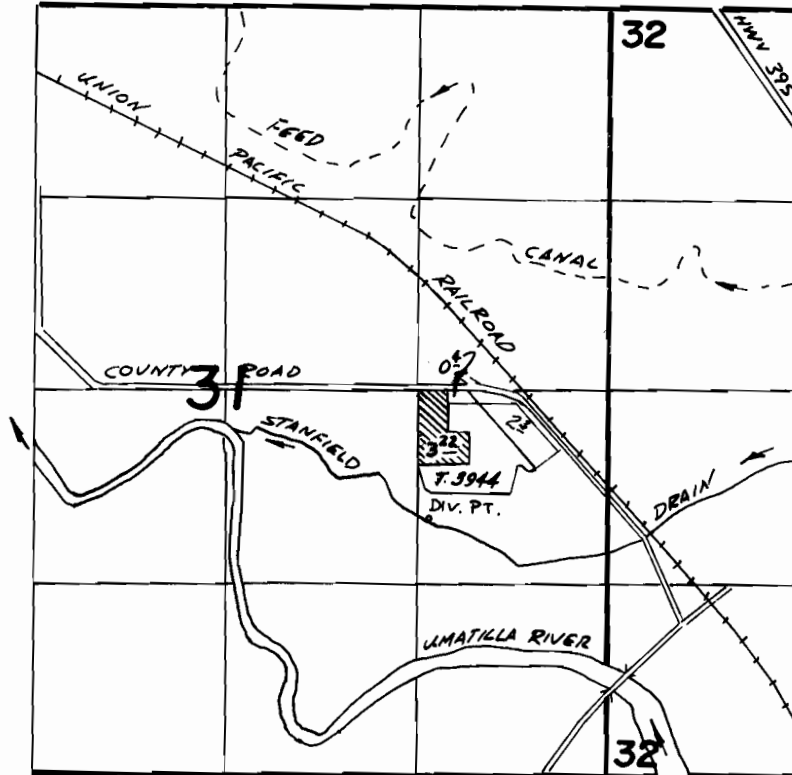

Div. Pt. Loc: 1770' N., 1230' W. From SE Cor. Sec. 31

FINAL PROOF SURVEY
UNDER

Application No. **57347** Permit No. **43323**
IN NAME OF

A. E. STALEY MANUFACTURING CO.

Surveyed *FEB. 24* 1983, by *V. L. Church*