

T. 4N., R. 29E., W.M.

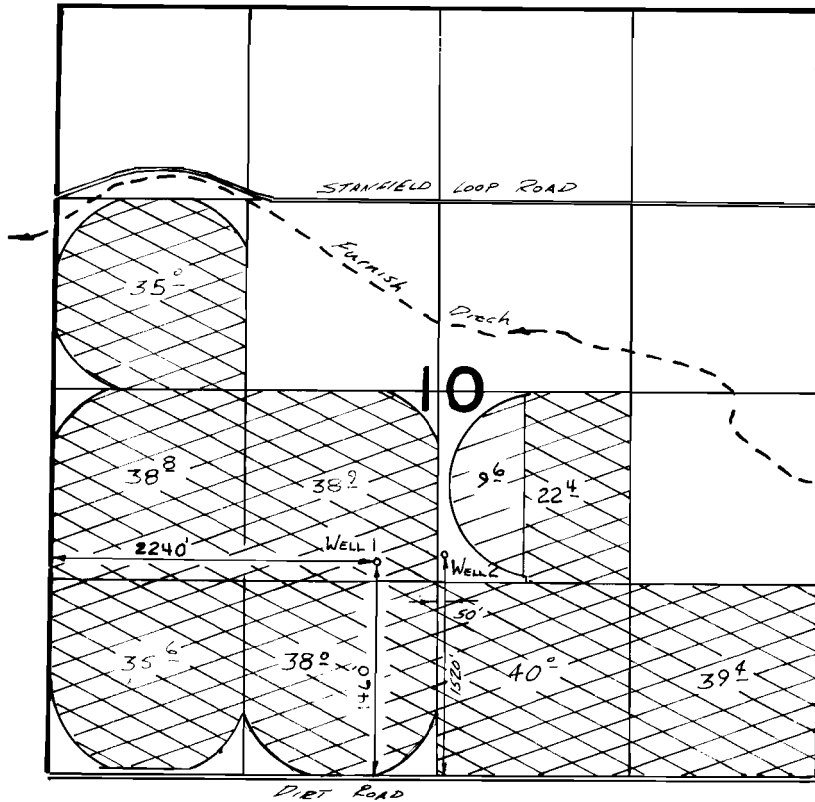

SCALE: 1" = 1320'

**FINAL PROOF SURVEY**  
UNDER

G-6575

G-6170 — 

Application No. **G-7573** Permit No. **G-7032** — 

IN NAME OF

**H.T. BURNS**

Surveyed *Nov. 24* 1982, by *V.L. Church*  
*May 1* 1983, by *R. Berwin*