

G 7367  
75838  
53680

# T. 3N. R. 29E. W.M.

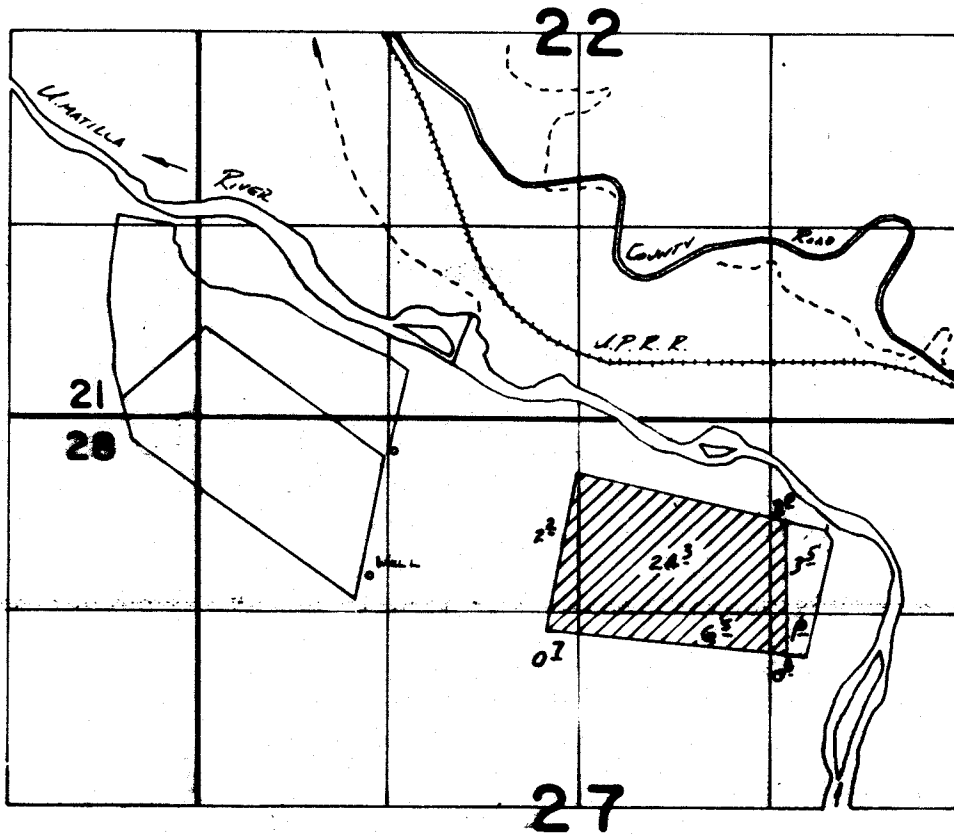

Well Loc: 1070'S. & 1180'E. FROM NW COR. SEC 27

## FINAL PROOF SURVEY UNDER

Application No. ~~G-7728~~ Permit No. ~~G-7367~~....  
IN NAME OF

**RON HOLEMAN**

Surveyed 3-16..... 1978., by ~~A. BASWIN~~.....

NZ-1111-17  
NZ-2111-15 2-13-81 JS