

# T. 5N. R. 29E. W.M.

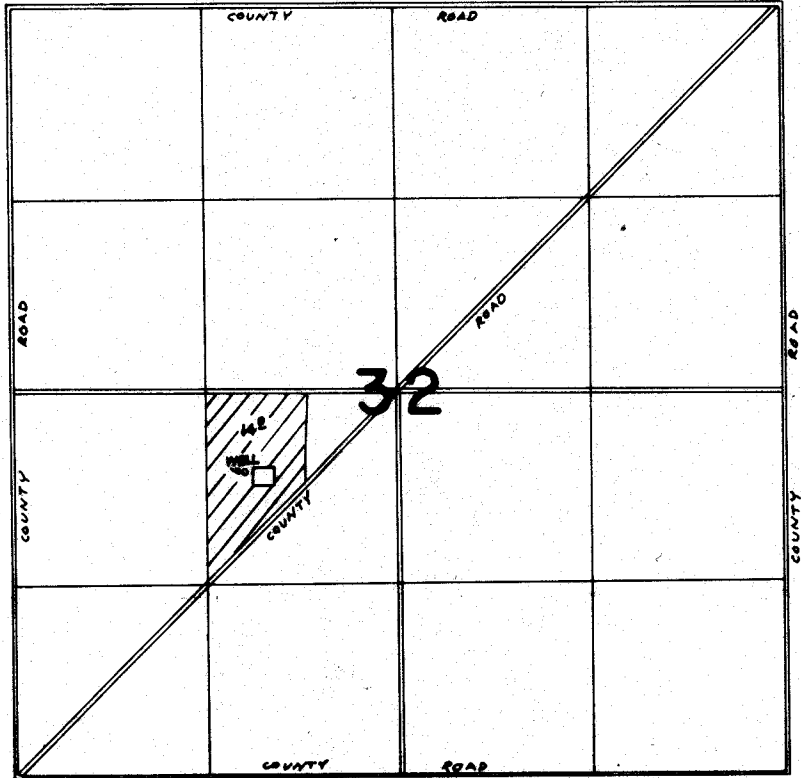

WELL LOC. 550'S & 1060'W FROM CENTER OF SEC 32

## FINAL PROOF SURVEY UNDER

Application No. G-8352.. Permit No. G-7750..  
IN NAME OF

.....**JOHN R. HALLADAY**.....

Surveyed 9-19..... 1972., by **R. BARWIN**.....