

T. 4N., R. 29E., W.M.

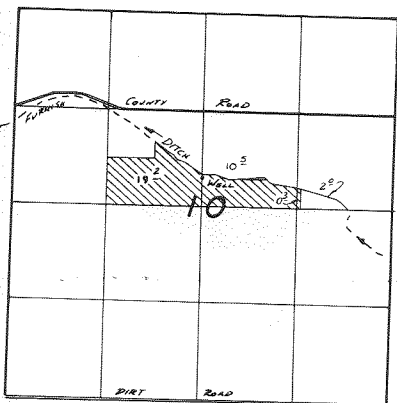

Well Loc: 390 N. 10 E. FROM CENTER COR SEC 10

FINAL PROOF SURVEY
UNDER

Application No. **G-9525** Permit No. **G-8819**
IN NAME OF

DEPT. OF VETERAN AFFAIRS

Surveyed ~~Nov 30~~ 1982, by *V.L. Church*