

T.4S., R.3 & 4 W., W.M.

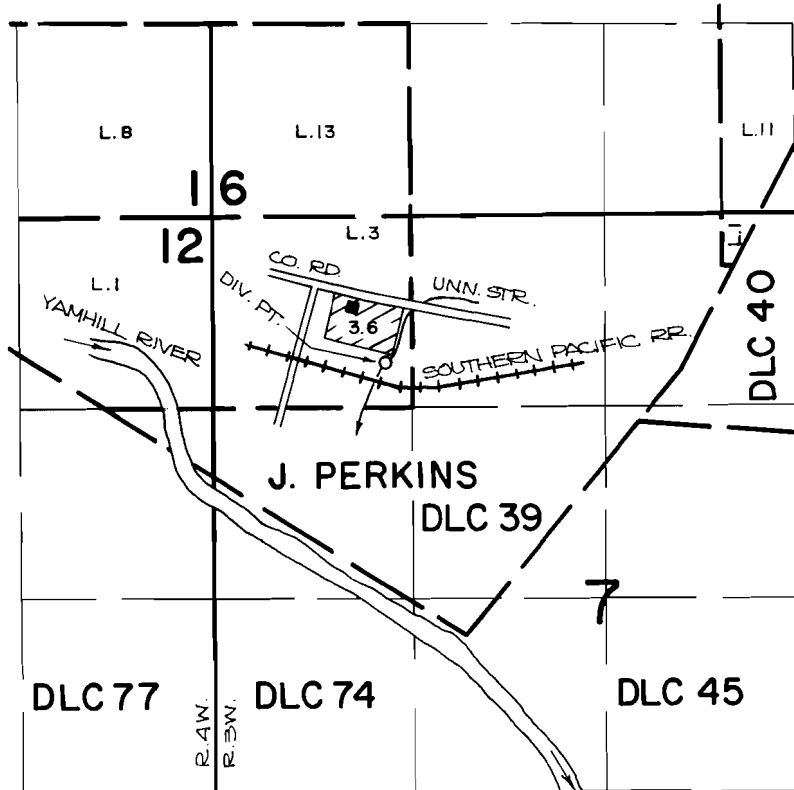

DIV. PT. LOCATION: 310 FT. N. AND 170 FT. W. FROM THE
S.E. CORNER OF LOT 3 IN SECTION 7.



SCALE: 4" = 1 MILE

FINAL PROOF SURVEY UNDER

Application No. 60405. Permit No. 45636.....
IN NAME OF

ROBERT ARTHUR BUTLER

Surveyed JUNE 19, 1984, by P. Paster.....