

T. 14 S., R. 5 W., W.M.

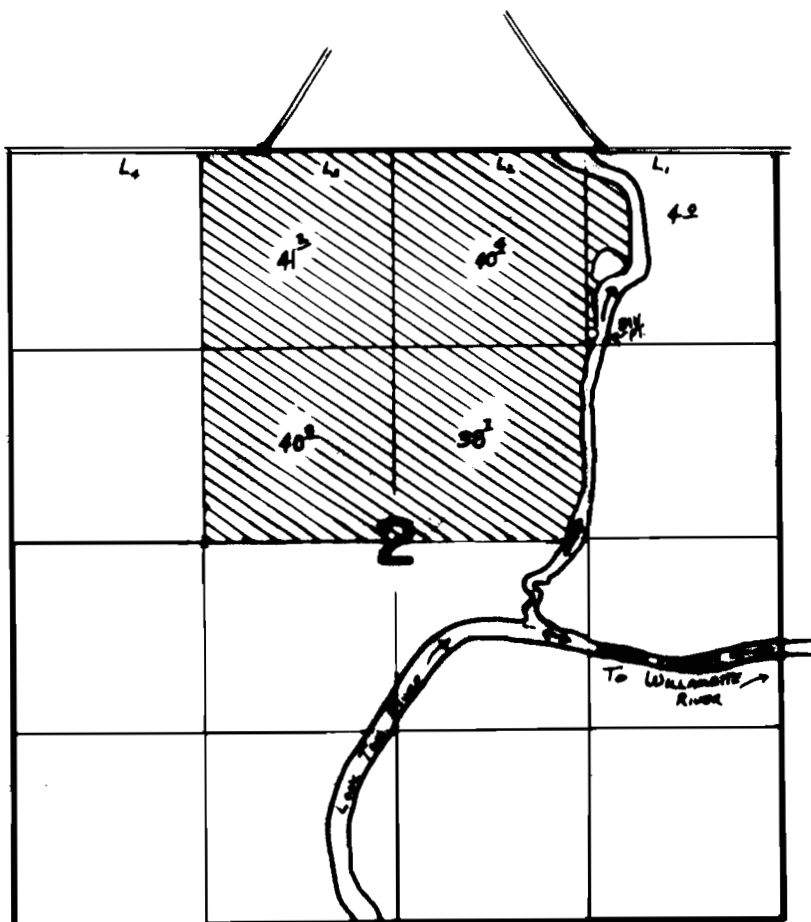

Div. Pt. Loc. : 1260' S. @ 1230' W. from the NE Cor. Sec. 2.

FINAL PROOF SURVEY UNDER

48243 41566
Application No. 55675 Permit No. 41587.....
IN NAME OF

.....GEORGE.....HORNING.....

Surveyed JULY 16, 1983, byL. TOLL.....