

T15S. R.38&39E. W.M.

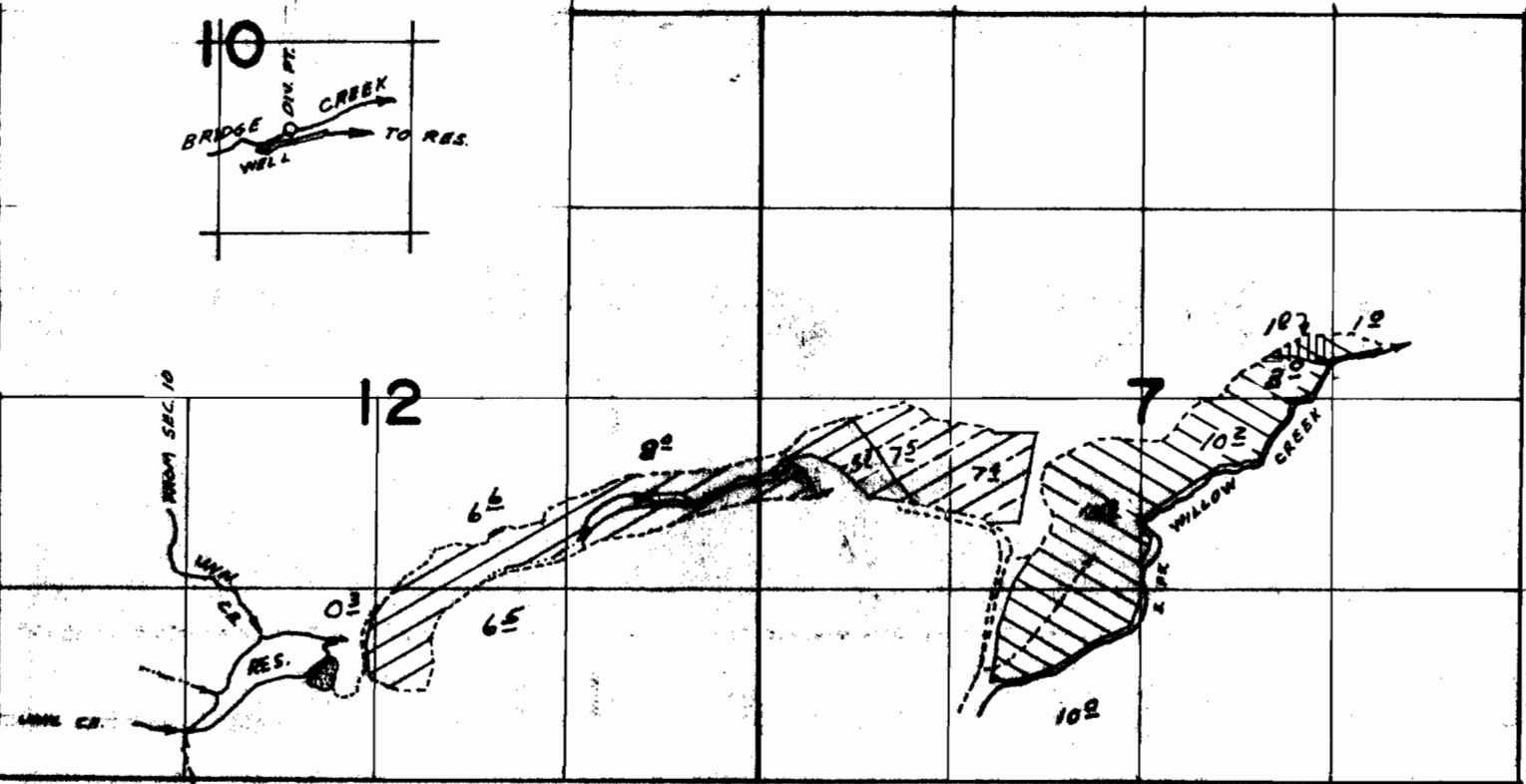
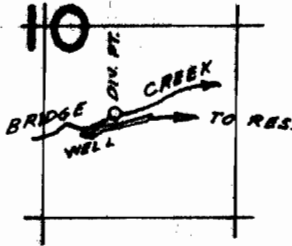

DIV. PT. LOC. 590'S & 500'E } BOTH FROM CENTER SEC. 10
 WELL LOC. 740'S & 270'E }
 DAM LOC. 1880'S & 410'W FROM CENTER SEC. 12

	PRIMARY PERMIT 17769		SUPPLEMENTAL PERMITS 18200 & U-342
	SUPPLEMENTAL PERMIT 17769		

FINAL PROOF SURVEY UNDER

Application No. 22579	Permit No. 17769
R-23045	R-931
23046	18200
U-372	U-342

IN NAME OF

ROSS & BERNIECE SIMPSON

Surveyed JUL. 20. 1953, by H. COFFMAN