

G5986

53174

5

T. 2N. R. 33E. W.M.

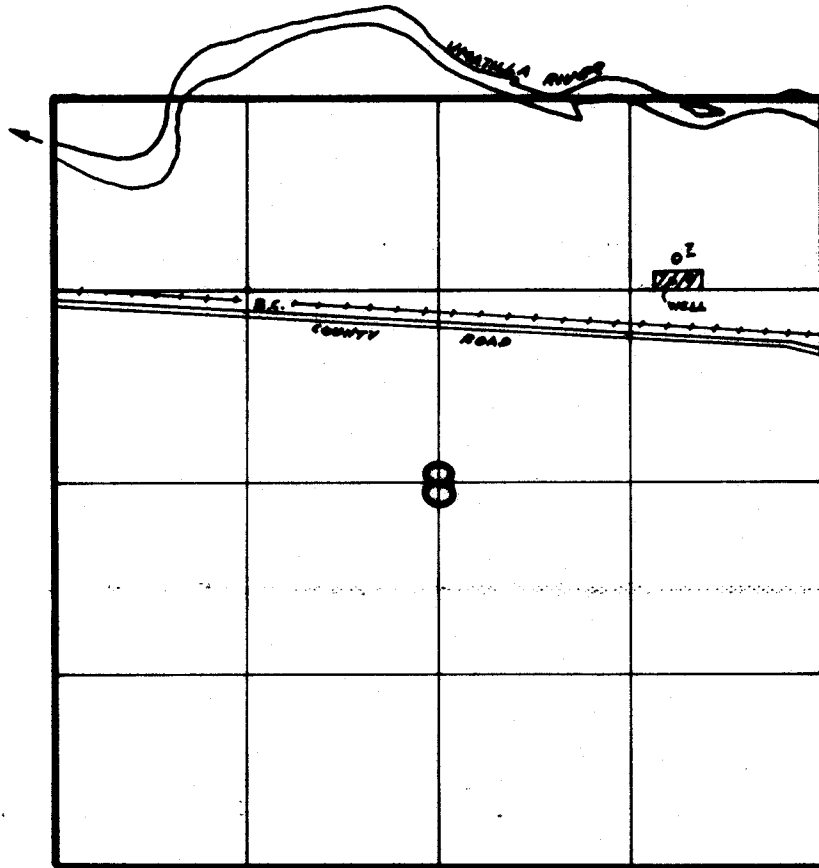

WELL LOCATED 1250'S & 1030'W FROM NE COR SEC 8

FINAL PROOF SURVEY
UNDER

Application No. G-6397. Permit No. G-5986.
IN NAME OF

MARVIN & RUTH BERLAND

Surveyed 1-31 1979 by V. CHURCH