

67153

53181

T. 6N. R. 35E. W.M.

WASHINGTON

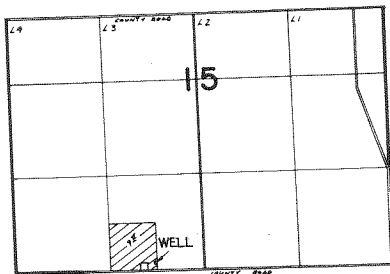

WELL LOCATED 120' N & 195' E FROM SW COR. SEC 15

FINAL PROOF SURVEY
UNDER

Application No. 67153 Permit No. 67153
IN NAME OF

HULETTE JOHNSON

Surveyed 3-29 1978, by R. BARWIN