

T. 1N., R. 32E., W. M.

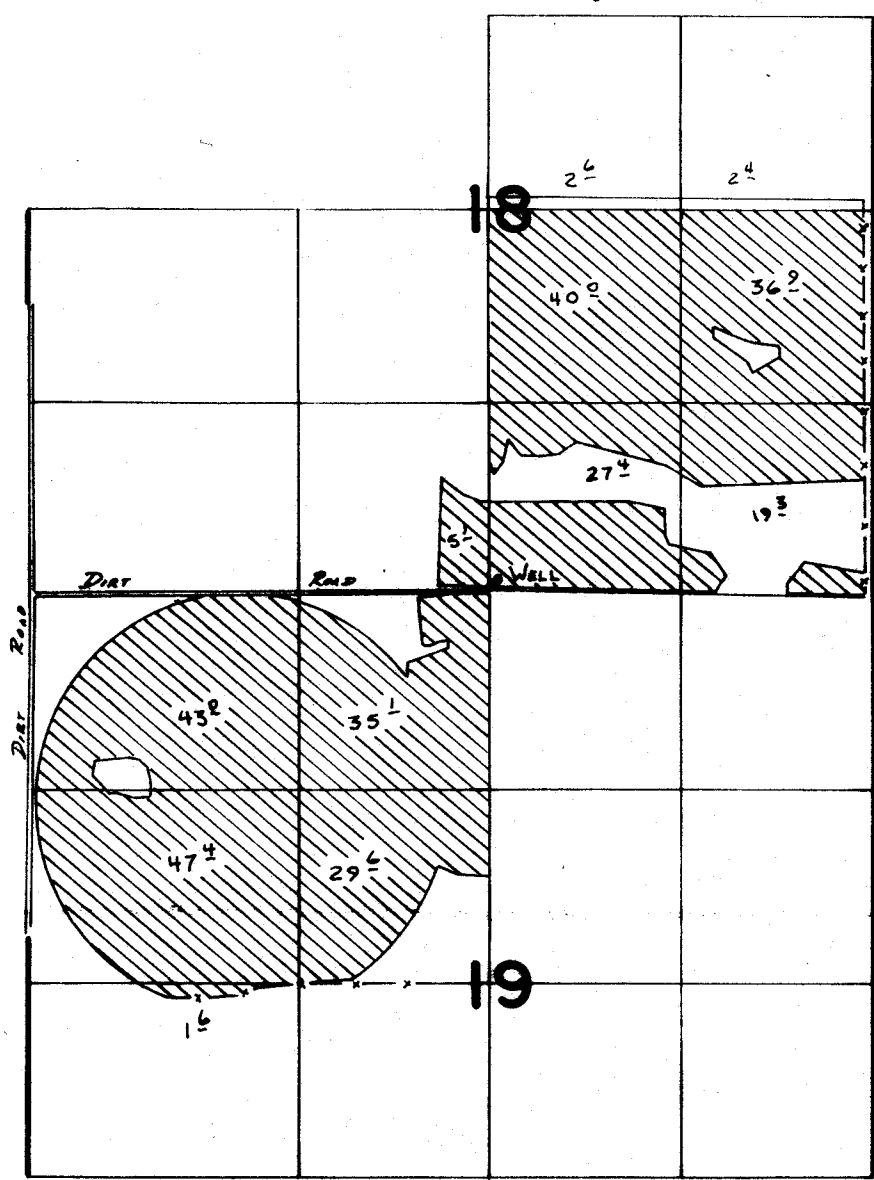

SCALE 1" = 1320'

WELL LOCATED 100' N. & 60' E. FROM S¹/₄ COR. SECTION 18

FINAL PROOF SURVEY
UNDER

Application No. **G:10607** Permit No. **G:9751**.....
IN NAME OF

JOHN M. & MARILYN P. OLSEN.....

Surveyed *May 18*... 19*84*., by *V.L.C. Church*.....